

EXHIBIT "A"

Water System's Right-of-Way No.	13950P
Real Estate File No.	P-212211
Water System's Work Order No.	TAJ69
Drawing No.	Exhibit "B" (RW13950P)
Council District No.	4
Coordinate File No.	186-126
Cadastral Map No.	186B125
Assessor's Parcel No.	2119-017-041
Thomas Bros. Map Grid No.	530-J4

Quitclaim 2 Feet by 20 Feet Widths Power Facilities Easement
 Within Lot 20 of Tract No. 20666, M.B. 633-10/13
 Vicinity of 7514 N. Reseda Boulevard, Los Angeles, CA 91335
NE/o the Intersection of Reseda Boulevard and Cohasset Street

The easterly 20 feet of the northerly 2 feet of Lot 20 of Tract No. 20666, in the City of Los Angeles, County of Los Angeles, State of California, as shown on map recorded in Book 633, Pages 10 through 13, inclusive, of Maps, in the office of the County Recorder of said County, lying within that certain 2 feet wide strip of land granted and dedicated to the City of Los Angeles for public utility purposes, the southerly line of said easement also shown as "Sly. line of a 2'x 20' public utility easement to the City of Los Angeles" on said Tract No. 20666.

The above-described strip of land contains an area of 40 square feet.

Exhibit "B" is attached hereto and made a part hereof.

This legal description was prepared under my direction.

Checked Date: 7/26/2024 <i>RJC/TSK - 7/26/2024</i>
Henry Bui Digitally signed by Henry Bui Date: 2024.07.26 07:10:40 -07'00'

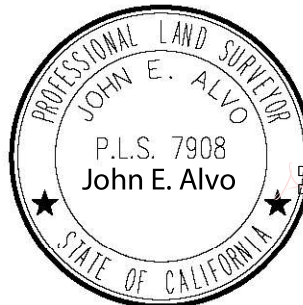

Digitally signed by John E. Alvo
 Date: 2024.07.26 07:12:34 -07'00'

Electronic File Path: \\Filer03\right-of-way\Projects\RW13950P\Legal_Description
 L13950P_186-126_Q_7514_Reseda_Bldv_Lot_20_TR_20666_2024-7-26.doc

PREPARED BY WATER SYSTEM SURVEYS & RIGHT-OF-WAY GROUP
--

