

EXHIBIT "A"

Right-of-Way No.	13825
Real Estate File No.	W-205388
Work Order No.	TAJ69
Drawing No.	Exhibit "B" (RW13825)
Council District No.	12
Coordinate File No.	210-111
Cadastral Map No.	210B109
Assessor's Parcel No.	2706-007-035
Thomas Bros Map Grid No.	500-C2

Quitclaim Portion of 30 Feet Wide Water Facilities Easement
 Within "Parcel 2" of Parcel Map Exemption No. AA-2005-8111-PMEX
 11029 N. Lurline Avenue, Los Angeles, CA 91311
N/o the Intersection of Lurline Avenue and Nashville Street

That certain portion of the northwest quarter of the southwest quarter of Section 8, Township 2 North, Range 16 West, of the Rancho Ex Mission de San Fernando, in the City of Los Angeles, County of Los Angeles, State of California, as shown on map recorded in Book 1, Pages 605 and 606, of Patents, in the office of the County Recorder of said County, included within a 30 feet wide strip of land granted to the City of Los Angeles as easement and right-of-way for the purposes of transporting, conveying, and distributing water, as described in Right of Way Deed recorded March 13, 1959 as Document No. 2935 in Book D398, Page 42, of Official Records, in the office of the County Recorder of said County, lying within "PARCEL 2" of Parcel Map Exemption No. AA-2005-8111-PMEX, as shown and described in "CERTIFICATE OF COMPLIANCE FOR LOT-LINE ADJUSTMENT" recorded August 1, 2006 as Instrument No. 06 1694821, of Official Records, in the office of said County Recorder.

The above-described strip of land contains an area of approximately 6,973 square feet.

Exhibit "B" is attached hereto and made a part hereof.

This legal description was prepared under my direction.

Checked Date: 4/9/2024
75X1290 - 4/9/2024
Henry Bui <small>Digitally signed by Henry Bui Date: 2024.04.09 09:18:53 -07'00'</small>

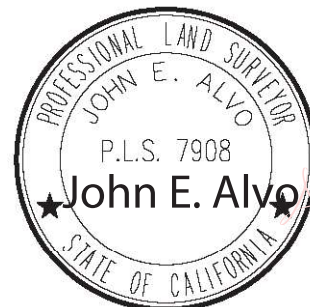

Digitally signed by John E. Alvo
Date: 2024.04.09 09:20:28 -07'00'

Electronic File Path: \\Filer03\right-of-way\Projects\RW13825\Legal_Description\
L13825P_210-111_Q_Water_E_PCL_2_PMAX_AA-2005-8111_11029_Lurline_Ave_2024-4-9

PREPARED BY WATER SYSTEM SURVEYS & RIGHT-OF-WAY GROUP
