

Century City

Property-Based Business Improvement District

Management District Plan



City of Los Angeles, California

January 2026

Prepared by:
Kristin Lowell, Inc.

*Prepared pursuant to the State of California
Property and Business Assessment District Law of 1994
And Article XIID of the California Constitution.*

**CENTURY CITY
Property-Based Business Improvement District
Management District Plan**

Table of Contents

<u>Section Number</u>	<u>Page Number</u>
1. Executive Summary	1
2. CCBID Boundary	4
3. CCBID Activity and Improvement Plan.....	8
4. CCBID Assessment Budget.....	13
5. Assessment Methodology	15
6. CCBID Governance	21
7. Assessment Roll.....	22

SECTION 1: EXECUTIVE SUMMARY

The Century City Property-Based Business Improvement District (“CCBID”) was first established in 2008, renewed in 2013, and 2022 and is now being renewed for an additional 10-year term pursuant to Section 36600 et seq. of the California Streets and Highways Code, the “Property and Business Improvement District Law as amended” hereinafter referred to as “State Law”, and the State Constitution Article XIID. Upon receipt of petitions signed by property owners representing greater than 50% of the assessable CCBID budget, the City of Los Angeles will initiate an assessment ballot procedure to officially renew the CCBID.

Governed by an Owners’ Association, commonly referred to as the Board of Directors, the CCBID’s work program will deliver enhanced services to improve and convey special benefits to properties located within the CCBID boundary, above and beyond those provided by the City of Los Angeles. The CCBID will continue to provide and expand upon the existing improvements and activities, specifically, clean, safe, and beautiful, as well as CCBID management services. In late 2026 it is anticipated that the new Metro station will open at the intersection of Constellation Boulevard and Avenue of the Stars in the heart of the CCBID. To account for the potential increase in pedestrian traffic to the area, each of the CCBID activities will be increased as well. Each of these activities is designed to meet the goals of the CCBID: to improve the appearance and safety of the area, to increase building occupancy and lease rates and to encourage new business development.

Location	The CCBID is approximately 13 block faces roughly bounded by Century Park West on the west, Santa Monica Boulevard medians to the north, Century Park East to Olympic Boulevard as well as Avenue of the Stars from Olympic Boulevard to Pico Boulevard to the east, and Pico Boulevard to the south. There are 509 parcels in the district with 209 individual owners. (See Section 3 for boundary description and map)
Benefit Zones	Both the State Law and the State Constitution Article XIID require that parcel assessments be levied in accordance with the special benefit each assessed parcel receives from the CCBID improvements and activities. To account for the varying needs of each assessed parcel, the CCBID is created with three benefit zones: the Zone 1, Zone 2 and Zone 3. Every assessed parcel within each benefit zone pays an assessment that represents 100% of the special benefits received. (See Section 3 for Benefit Zone discussion)
Services & Activities	<p>The CCBID will finance services that will enhance the environment for property owners, businesses, residents, employees, and visitors, including:</p> <p>Clean, Safe, and Beautiful:</p> <ul style="list-style-type: none"> • <u>Safe Team</u> that supports law enforcement, property owners and businesses in overall crime prevention efforts while providing concierge service to customers, residents, and employees. • <u>Clean Team services</u> that will sweep sidewalks and gutters, empty trash cans, remove litter, trash, and graffiti throughout the District.

	<ul style="list-style-type: none"> • <u>Landscaping and Fountain Maintenance</u> such as landscaping medians and corridors, tree trimming on medians, maintaining fountains and pedestrian walkways. • <u>Beautification</u> such as, streetscape furniture, bike racks, tree lighting, information kiosks, holiday décor, art, and signage. <p>CCBID Management: The improvements and activities are managed by a professional staff that requires centralized administrative support. Management staff oversees the District’s services which are delivered seven days a week.</p>																								
Method of Financing	Levy of assessments upon real property that receive special benefits from the CCBID improvements and activities.																								
Budget	<p>Total CCBID budget for its first year of operations is \$3,800,000, as follows:</p> <table border="1" data-bbox="540 814 1367 1161"> <thead> <tr> <th>EXPENDITURES</th> <th>TOTAL BUDGET</th> <th>% of Budget</th> </tr> </thead> <tbody> <tr> <td>Clean, Safe and Beautiful</td> <td>\$3,100,000.00</td> <td>81.58%</td> </tr> <tr> <td>Management</td> <td>\$700,000.00</td> <td>18.42%</td> </tr> <tr> <td>Total Expenditures</td> <td>\$3,800,000.00</td> <td>100.00%</td> </tr> <tr> <th>REVENUES</th> <td></td> <td></td> </tr> <tr> <td>Assessment Revenues</td> <td>\$3,686,000.00</td> <td>97.00%</td> </tr> <tr> <td>Other Revenues (1)</td> <td>\$114,000.00</td> <td>3.00%</td> </tr> <tr> <td>Total Revenues</td> <td>\$3,800,000.00</td> <td>100.00%</td> </tr> </tbody> </table> <p>(1) An allowance is made for general benefits that the CCBID may provide to either the parcels outside the CCBID boundary or to the public at large. Any CCBID services that are found to provide general benefit cannot be paid for with assessment revenue. A certified engineer has estimated that the general benefit from the CCBID services accounts for \$114,000 of the estimated budget, resulting in a total assessable budget of \$3,686,000.</p>	EXPENDITURES	TOTAL BUDGET	% of Budget	Clean, Safe and Beautiful	\$3,100,000.00	81.58%	Management	\$700,000.00	18.42%	Total Expenditures	\$3,800,000.00	100.00%	REVENUES			Assessment Revenues	\$3,686,000.00	97.00%	Other Revenues (1)	\$114,000.00	3.00%	Total Revenues	\$3,800,000.00	100.00%
EXPENDITURES	TOTAL BUDGET	% of Budget																							
Clean, Safe and Beautiful	\$3,100,000.00	81.58%																							
Management	\$700,000.00	18.42%																							
Total Expenditures	\$3,800,000.00	100.00%																							
REVENUES																									
Assessment Revenues	\$3,686,000.00	97.00%																							
Other Revenues (1)	\$114,000.00	3.00%																							
Total Revenues	\$3,800,000.00	100.00%																							
Budget Surplus	Any annual budget surplus (maximum of 10%), including those created through cost saving measures, unexpected reductions in expenses or unanticipated increases to income, will be rolled into the following year’s budget, including surpluses from the prior CCBID 2026 budget. The budget will be adjusted accordingly consistent with the Management District Plan to adjust for surpluses that are carried forward to ensure that the CCBID is spending these funds in a timely manner and is complying with applicable State laws and City policies. The estimated budget surplus amount will be included in the annual report each year.																								

<p>Assessments</p>	<p>Annual assessments are calculated based upon each parcel's special benefit received from the identified CCBID improvements and activities and their relative cost. The assessment factors are based on the building square footage for developed parcels and lot square footage for undeveloped vacant parcels. The first year's assessment rates, including residential parcels, per building square foot for developed parcels and lot square foot for vacant parcels are:</p> <table border="1" data-bbox="651 495 1256 638"> <thead> <tr> <th>Benefit Zone</th> <th>Assmt Rate</th> </tr> </thead> <tbody> <tr> <td>Zone 1</td> <td>\$0.3346</td> </tr> <tr> <td>Zone 2</td> <td>\$0.2012</td> </tr> <tr> <td>Zone 3</td> <td>\$0.0838</td> </tr> </tbody> </table>	Benefit Zone	Assmt Rate	Zone 1	\$0.3346	Zone 2	\$0.2012	Zone 3	\$0.0838
Benefit Zone	Assmt Rate								
Zone 1	\$0.3346								
Zone 2	\$0.2012								
Zone 3	\$0.0838								
<p>Increases</p>	<p>During the 10-year term annual assessments may increase up to 10% to take into consideration the increase in program costs as well as the increased cost of activities once the Metro station opens in early 2027. Assessment budgets may also increase based on development in the CCBID. The determination of annual adjustments in assessment rates will be subject to the review and approval of the CCBID Owners' Association. The CCBID Owners' Association will develop annual budgets and service programs each year.</p>								
<p>City Services</p>	<p>The City of Los Angeles has established and documented the base level of pre-existing City services. The CCBID will not replace any pre-existing general City services.</p>								
<p>Collection</p>	<p>CCBID assessments appear as a separate line item on the annual Los Angeles County property tax bills.</p>								
<p>CCBID Governance</p>	<p>The CCBID will be managed by a nonprofit organization that will act as the CCBID Owners' Association. The CCBID Owners' Association will be governed by a board of directors comprised of a majority of CCBID property owners. The Board will determine CCBID annual services and budgets.</p>								
<p>CCBID Formation</p>	<p>The State Law for district formation requires the submission of petitions signed by property owners in the proposed CCBID who will pay more than 50% of the total assessments (i.e., petitions must represent more than 50% of the \$3,686,000 to be assessed). Petitions are submitted to the City of Los Angeles, and they will mail ballots to all assessed property owners. The majority of ballots returned, as weighted by assessments to be paid, must be in favor of the CCBID in order for the City Council to consider approval.</p>								
<p>Duration</p>	<p>The CCBID will have a 10-year life beginning January 1, 2027, through December 31, 2036. Any subsequent renewal of the CCBID will require a new Management District Plan, petition, and ballot process.</p>								

SECTION 2: CCBID BOUNDARY

CCBID Boundary

The CCBID is approximately 13 block faces roughly bounded by Century Park West on the west, Santa Monica Boulevard medians to the north, Century Park East to Olympic Boulevard as well as Avenue of the Stars from Olympic Boulevard to Pico Boulevard to the east, and Pico Boulevard to the south. There are 509 parcels in the district with 209 individual owners.

Beginning at the northeast corner of parcel number 4319-003-902 (Santa Monica Boulevard median), thence south along the eastern boundary line said parcel and across Santa Monica Boulevard to the northeast corner of parcel number 4319-001-015; thence south along the eastern boundary line said parcel to its southeast corner; thence west along the southerly boundary line of said parcel to the northeast corner of parcel number 4319-001-904; thence south along the eastern property line of parcels facing on the east side of Century Park East to the centerline of W. Olympic Boulevard; thence west along the centerline of W. Olympic Boulevard to the eastern boundary line of the Avenue of the Stars median; thence south along the eastern boundary line of the Avenue of the Stars median to the north side of Pico Boulevard; thence west along the north side of Pico Boulevard to the southwest corner of parcel number 4315-019-013; thence north the western parcel line of said parcel to the centerline of Olympic Boulevard; thence east along the centerline of Olympic Boulevard to southerly prolongation of the western boundary line of the parcel on the northwesterly corner of Olympic Boulevard and Avenue of the Stars (the Century Condos); thence north along the western boundary line of said parcel to the southeasterly corner of parcel number 4319-004-160; thence west along the southern parcel line of said parcel to its southwesterly corner; thence north along the western parcel line of said parcel to the southerly boundary line of parcel number 4319-004-141; thence west along the southerly boundary of said parcel and across Century Park West to the western boundary line of the landscaped corridor on the west side of Century Park West; thence north along the western boundary line of said landscaped corridor and across Santa Monica Boulevard to the northwesterly corner of parcel number 4319-003-901; thence east along the northern boundary line of the Santa Monica Boulevard median to the point of beginning.

CCBID Boundary Rationale

The primary parcel uses within the CCBID boundaries are a mix of retail, office, parking and residential. The CCBID improvements and activities are designed to provide special benefits to each of the individual assessed parcels; to improve the appearance and safety of the area, to increase building occupancy and lease rates, to encourage new business development and attract wholesale serving businesses and customers. All the CCBID improvements and activities are over and above the City's baseline of services and are not provided by the City, and each of the services provide particular and distinct benefits to each of the individual assessed parcels within the CCBID. In order to ensure that parcels outside of the CCBID will not specially benefit from the improvements and services funded with the assessment, improvements and services will only be delivered to individual assessed parcels within the boundaries of the CCBID and will not extend beyond.

NORTHERN BOUNDARY: Santa Monica Blvd Median

Santa Monica Boulevard median between Moreno Drive and just west of Century Park West is the northern CCBID boundary. The median itself (APNs 4319-003-901, 902) due to its high pedestrian traffic and as the gateway to Century City needs the CCBID services and therefore

will be assessed for its proportional special benefit. Since Santa Monica Boulevard is a major arterial street with 3 lanes in either direction it poses safety issues for the day porter and safety teams to cross the entire width of the street. Most of the land uses on the northern side of Santa Monica Boulevard are a fenced in country club and uses not consistent with those in the CCBID. Therefore, no CCBID services will be provided north of the Santa Monica Boulevard median.

WESTERN BOUNDARY: Century Park West and Avenue of the Stars

The west side of Century Park West between Santa Monica Boulevard and Solar Way is a solid fence line and tree hedge row that separates Century Park West and the of the residential community to the west. These parcels do not have access off of Century Park West and will not receive any of the CCBID services or special benefits and therefore are not included in the boundary. APN 4319-004-142, the MTA layover zone, is in the CCBID boundary but will not receive any special benefit from the CCBID services as its use is not commerce driven and is not consistent with other uses in the CCBID. It is a public transit layover zone for buses only and is not a parcel that engages in commerce or has public access. The two parcels (APNs 4319-004-141, 160) behind the MGM Tower (APN 4319-004-140) are included in the boundary as they are the parking structures for the tenants and visitors to the area. Their primary access is from MGM Drive which is off of Constellation Boulevard not Century Park West and therefore will receive the CCBID services. The fenced in residential condominium development just south of the parking structures are not included in the boundary since the CCBID services only extend as far south as Solar Way on Century Park West and do not continue any further. The CCBID will not provide any services to the fenced in gated condo development nor will the CCBID provide any services to the sidewalk or street immediately adjacent to these parcels. The western boundary then extends to the western property line of the Century Condos and 4315-019-005 on the southwest corner of Olympic Boulevard and Avenue of the Stars. The CCBID services will only be delivered on W Olympic Boulevard to the western property lines of these parcels and will not be delivered beyond. The western boundary then extends south on Avenue of the Stars to include the frontage of APN 4315-019-006 and the Fox Studios. CCBID services will not be delivered to any other frontage of Fox Studios other than their frontage on Avenue of the Stars.

SOUTHERN BOUNDARY: Olympic Boulevard and Pico Boulevard

The southern boundary begins at the centerline of W Olympic Boulevard to the Avenue of the Stars median and proceeds south along the eastern side of the median to Pico Boulevard. It then heads west to the eastern parcel line of parcel number 4315-019-013 (Fox Studios). The CCBID services are only delivered to Fox Studios for its frontage along Avenue of the Stars. No services will be delivered to any other frontage of the Fox Studios. Olympic Boulevard and Pico Boulevard serve to delineate the business corridor from the residential community of Century City. The residential condominium developments are fenced in and provide self-inclusive security and maintenance. These condominium projects do not have their primary access on Avenue of the Stars. The fenced-in condominium projects are excluded from the CCBID boundaries because CCBID services will not be provided to those fenced-in condo projects and therefore do not receive special benefit from said services.

EASTERN BOUNDARY: The City Limit line

The City Limit line is the boundary to the east between the Santa Monica Boulevard median and the centerline of Olympic Boulevard, which is the jurisdictional boundary separating the City of Los Angeles and the City of Beverly Hills. The eastern boundary continues down the eastern boundary of the Avenue of the Stars median until Pico Boulevard. The residential condominium developments east of Avenue of the Stars are fenced in and provide self-inclusive security and maintenance services. These condominium projects are excluded from the CCBID boundaries

because CCBID services will not be provided to those fenced in condo developments and therefore do not receive special benefit from the proposed services.

Benefit Zones

There are three benefit zones within the CCBID; Zone 1 includes every parcel that has primary frontage along Avenue of the Stars, except for those parcels expressly exempted, as detailed herein. Zone 2 includes the Westfield Mall APN and the Fox Studios APN 4315-019-013. Zone 3 includes every other parcel within the CCBID boundary not included in either Zone 1 or Zone 2. See the map on the following page for benefit zone designations.

Zone 1

Due to the highest concentration of office use and pedestrian traffic, the individual assessed parcels in the Zone 1 will receive the highest level of CCBID services. They will benefit from all the district-wide services such as the Clean Team, Safe Team, Beautification, and Landscaping. In addition to these services, the individual assessed parcels in the Zone 1 will also receive a higher level of landscaping to maintain the Avenue of the Stars medians as well as maintain the median fountains. The Zone 1 individual assessed parcels will pay 100% of the special benefits it receives from the CCBID services.

Zone 2

Zone 2 consists solely of the Westfield Mall parcel (APN 4319-003-083) and the Fox Studios parcel (APN 4315-019-013). These two parcels are unique in both their use and their location in the district. The Westfield Mall's primary access is not on Avenue of the Stars (Zone 1), but on either Constellation Boulevard or Santa Monica Boulevard, which would place it in Zone 3. However, the Mall generates much of the pedestrian traffic in the district and is anticipated to greatly benefit from the ridership from the new Metro Station. The Fox Studios parcel's main entrance is on Pico Boulevard, which does not receive any CCBID services. CCBID services are only provided on Avenue of the Stars to Pico Boulevard. Due to the unique nature and use of both of these parcels they will receive the same CCBID services as those in Zone 1 but to a lesser degree. These two parcels will pay 100% of the special benefits they receive from the CCBID services.

Zone 3

The individual assessed parcels in the Zone 3 will receive all the CCBID district-wide services including the Clean Team, Safe Team, Landscaping and Beautification. The pedestrian traffic in the Zone 3 is significantly less than in Zones 1 or 2, so their need and special benefit from the CCBID services is also significantly less. Zone 3 also includes the Santa Monica medians from parcel lines 4319-003-901 to 4319-003-902 which will receive services over and above the City's current level of service it provides to the medians. The Zone 3 individual assessed parcels will pay an assessment rate equal to 100% of the special benefits received.

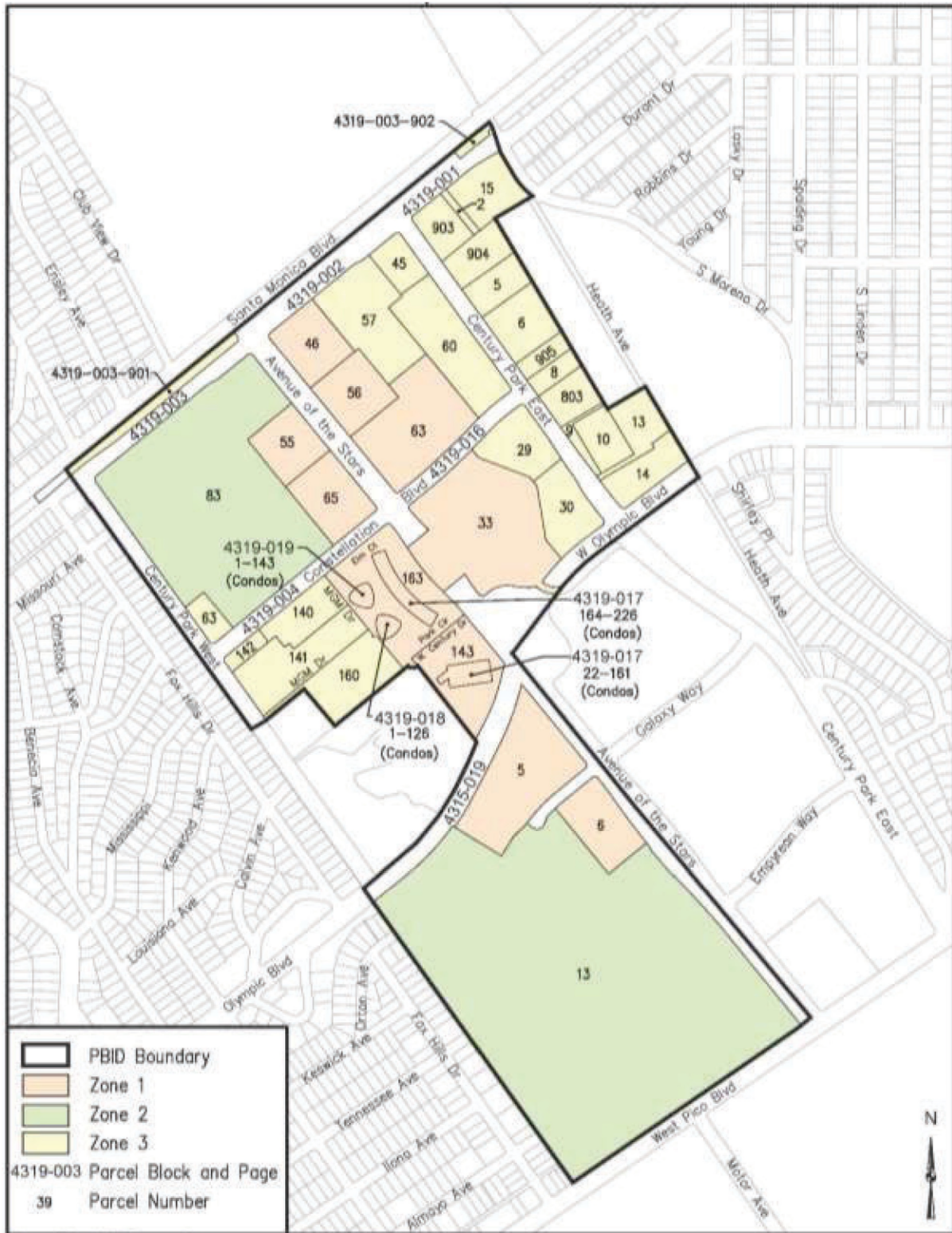

Prepared by KLI Finance, Inc.
 Filename: PBID-Map3 - 8/27; JM

SECTION 3: CCBID ACTIVITY AND IMPROVEMENT PLAN

Background

Through a participatory process that included meetings with property owners and/or building managers, the Century City BID renewal committee collectively determined the CCBID priorities for improvements and activities that include safety, cleaning, beautification, and management. The specially benefitted parcels within the boundaries of the CCBID are a unique mix of retail, office, parking and residential. The CCBID improvements and activities are designed to provide special benefits to each of the individual assessed parcels: to improve the appearance and safety of the area, to increase building occupancy and lease rates, to encourage new business development. All the CCBID improvements and activities are over and above the City's baseline of services and are not provided by the City, and each of the services provide particular and distinct benefits to each of the individual assessed parcels within the CCBID. In order to ensure that parcels outside of the CCBID will not specially benefit from the improvements and services funded with the assessment, improvements and services will only be delivered to individual assessed parcels within the boundaries of the CCBID and will not extend beyond.

Based upon these findings, the following narrative provides recommendations for the CCBID's first year of operation. CCBID activities may be amended in subsequent years within the following general categories. In early 2027, it is anticipated that the new Metro station will open at the intersection of Constellation Boulevard and Avenue of the Stars in the heart of the CCBID. "When the full nine-mile extension from Wilshire/Western Station to the VA Campus is completed, Metro projects the D Line will attract 53,000 new daily riders."¹ To account for the potential increase in pedestrian traffic to the area, each of the CCBID activities will be increased to address the increased demand for CCBID services and activities. Final activities and budgets will be subject to the review and approval of the CCBID Owners' Association prior to City Council approval.

Clean, Safe and Beautiful

\$3,100,000/81.58%

To respond to stakeholder priorities and guiding principles to make Century City more welcoming, clean and beautiful, the CCBID will continue to fund and expand upon the existing safety, cleaning and beautification efforts. The CCBID activities are intended to improve commerce and quality of life by making each individually assessed parcel safer, cleaner and more attractive, which will encourage investment dollars and generate additional pedestrian traffic. The following is a multi-dimensional approach for providing a safer, cleaner and more aesthetically appealing district.

Safe Team

The Safe Team will provide safe services for the individual parcels located within the CCBID in the form of bike and car and foot patrols. The purpose of the Safe Team is to prevent, deter and report illegal activities taking place in the public rights-of-way including streets, sidewalks, storefronts, medians, and public alleys. The presence of the Safe Team is intended to deter such illegal activities as vandalism, graffiti, narcotic use or sales, public urination, trespassing, drinking in public, prostitution, illegal panhandling, and illegal dumping. The Safe Team activities will supplement, not replace, other ongoing police, security and patrol efforts within the CCBID.

¹ "Aerial perspective on Metro's \$9.5B subway extension to the Westside" <https://la.urbanize.city/>, April 2, 2025

Currently the Safe Team is deployed with one officer on duty and 16 hours of coverage between 7AM to 11PM on weekdays and 8 hours of coverage 11AM to 7PM on Saturdays. Once the Metro station opens it is anticipated that the Safe Team will increase to 3 officers on duty with 24 hours of continuous coverage 7 days a week. In addition, the safety patrol may include an Outreach Ambassador to assist those that are experiencing homelessness and connecting them to appropriate service organizations. The CCBID may also add off-duty police officers to respond to increased vandalism during the evening and weekends.



The Safe Team creates a safe and secure environment for each assessed parcel in the CCBID. An unsafe environment deters commerce and may fail to attract patrons and visitors and reduce commercial rents and commercial occupancies. This activity is designed to increase vehicular and pedestrian traffic, increase commerce and customer activity, attract and retain new business and patrons, and may increase lease rates and occupancies for the assessed parcels within the CCBID boundaries. The Safe Team only provides its services within the CCBID boundaries. The special benefit to parcels from these services is increased commercial activity which directly relates to increases in lease rates and customer usage. A district that is perceived as unsafe deters pedestrian and commercial activity.

Commercial parcels benefit from the Safe Team activities that work to provide greater pedestrian traffic, increased sales, enhanced business climate, new business attraction, business retention, and increased business investment which all works to increase occupancy and enhance the business climate, new business attraction, business retention and business investment. Retail parcels benefit from Safe Team activities that work to provide greater pedestrian traffic, increased sales and an enhanced business climate. Residential parcels benefit from Safe Team activities that provide an enhanced sense of safety and a positive user experience which in turn improves the business climate and business offering and attracts and retains residents. Office parcels benefit from Safe Team activities that work to provide greater pedestrian traffic, an enhanced business climate, new business and tenant attraction, business/tenant retention, and increased business investment. Publicly owned parcels benefit from Safe Team activities which work to provide greater pedestrian traffic and increased use which translates into fulfilling their public service mission.

Safety Technology

In addition to the Safe Team, the CCBID may invest in a high level technology program to enhance safety throughout the district. Such services may include video cameras, license plate recognition cameras or other technology solutions. Adding video cameras and license plate reading cameras significantly enhances overall security by providing a layered and proactive approach to crime prevention and response. The visible presence of surveillance cameras as well as license plate reading cameras acts as a strong deterrent to criminal activity such as theft, vandalism, and loitering. Importantly, the presence of surveillance technology increases public confidence, making the area feel safer for employees, residents, and visitors. This perceived and actual safety can encourage more foot traffic and economic activity, benefiting the entire district. Overall, the integration of security cameras creates a safer, more secure commercial environment.

Clean Team

To consistently deal with cleaning issues, the Day Porter will continue to provide services as it has since CCBID inception in 2008. The Day Porter will only provide services to individual assessed parcels within CCBID boundaries. These cleaning services are not to replace existing City cleaning services, but to complement and enhance what is currently provided. Therefore, no assessment funding will be used to provide baseline City services. In order to effectively deal with the cleaning issues in the CCBID, a multi-faceted approach has been developed that may consist of the following elements;

- Power washing
- Sweeping sidewalks and gutters
- Cleaning up litter
- Removing illegal signs/posters/stickers
- Removing graffiti
- Emptying trash cans
- Removing illegal dumping and/or untidy conditions

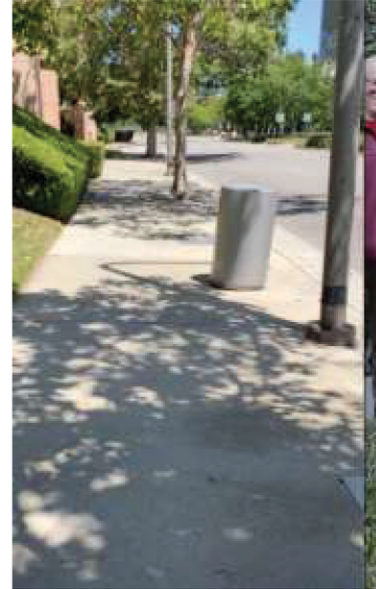

Currently the Day Porter activities are provided 8 hours per day, 5 days a week. Once the Metro station opens it is anticipated these activities will increase to 16 hours a day, 7 days a week.

Landscaping and Fountain Maintenance

In addition to the general cleaning and public safety services, landscaping the corridors will be provided for all the medians (including Santa Monica Boulevard median), and landscaped corridors throughout the CCBID. The landscape maintenance services may include, but not necessarily be limited to:

- Tree pruning on medians and Olympic Boulevard cloverleafs
- Median and corridor landscaping on Avenue of the Stars, the cloverleafs on the north and south side of the interchange at Olympic Boulevard, the Santa Monica Boulevard medians, and the landscaped corridors along Century Park West
- Seasonal flowers
- Replacing irrigation equipment



Basic maintenance of the two iconic fountains in the medians on Avenue of the Stars will also be provided through the CCBID. The fountains were installed more than six decades ago as an integral part of the design of the “City of the Future.” They help to define Century City as a sophisticated and unique destination for both businesses and investors. The fountains are important and internationally recognized iconic symbols that have been as much a part of Century City as the elegant office buildings, unique hotels and residential towers that have been built

around them. They anchor the landscaped medians and provide an aesthetic element of progressive urban attention that defines the center of Century City's grand boulevard. The fountains are a key part of Century City's history and identity now and in the future. The fountain maintenance services may include, but not necessarily be limited to:

- Replacing pumps, motors, expansion joints, horizontal manifold lines, equipment and drains
- Replacing lighting (various parts and/or main receptacle)
- New electrical equipment and wiring
- Add wind speed controls

Beautification

In addition to the general cleaning and safety programs for the purposes of improving commerce to each individual assessed parcel, the CCBID may also provide highly visible improvements that will add to the attractiveness of public spaces, such as cosmetic improvements to the landscape and streetscape on the public rights-of-way throughout the CCBID. While Century City has been well maintained, the beautification needs continued refreshing and updating. These improvements may include but not necessarily be limited to:



- Street furniture, such as benches, trash receptacles and kiosks
- Signage to help visitors navigate through the CCBID
- Gateway signage
- Public art
- Tree lighting
- Seasonal holiday decorations and banners

The following table itemizes each of the CCBID services by benefit zone.

CCBID Services	Zone 1	Zone 2	Zone 3
Sweeping sidewalks	X	X	X
Graffiti removal and illegal signs/posters/ stickers	X	X	X
Safe Team	X	X	X
Tree pruning	X	X	X
Day Porter	X	X	X
Fountain maintenance	X	X	
Landscaping	X	X	X
Replacing irrigation equipment	X	X	X
Tree lighting	X	X	
Seasonal flowers	X	X	
Street furniture	X	X	X
Signage	X	X	X
Seasonal holiday décor and banners	X	X	X

The Clean Team, Landscaping and Fountain Maintenance and Beautification will only be provided to assessed parcels within the CCBID boundary. The special benefit to assessed parcels from these services is increased commercial activity which directly relates to increases in lease rates and customer usage. Dirty and unclean sidewalks deter pedestrians and commercial activity.

Commercial parcels benefit from these activities that provide greater pedestrian traffic, increased sales, an enhanced business climate, new business attraction, business retention, and increased business investment. This all works to increase occupancy and enhance the business climate, new business attraction, business retention and business investment. Retail parcels benefit from these activities that work to provide greater pedestrian traffic, increased sales and an enhanced business climate. Residential parcels benefit from these activities that provide an enhanced sense of cleanliness and a positive user experience which in turn improves the business climate and business offering and attracts and retains residents. Office parcels benefit from these activities that that work to provide greater pedestrian traffic, an enhanced business climate, new business and tenant attraction, business/tenant retention, and increased business investment. Publicly owned parcels benefit from these activities which work to provide greater pedestrian traffic and increased use which translates into fulfilling their public service mission.

Administration and Management

\$700,000/18.42%

Like any business, the CCBID will require a professional staff to properly manage programs, communicate with stakeholders and provide leadership. The CCBID supports a professional staff that delivers the CCBID activities to the assessed parcels within the CCBID boundary.

Management services may include compensation for an Executive Director, an administrative assistant or any other staff member, or subcontractor the Owner's Association deems necessary to manage the CCBID programs. The management team is responsible for providing the day-to-day operations. CCBID funds may be used to leverage additional monies from sponsorships, contracts, grants and earned income. Additional administrative costs may include accounting and annual financial reviews, insurance, legal, program support costs including supplies, equipment and rent, assessment collection fee, and other administration costs associated with the overhead and administrative support of programs. The special benefit to assessed parcels from these services is increased commercial activity which directly relates to increases in lease rates and enhanced commerce.

SECTION 4: CCBID ASSESSMENT BUDGET

2027 CCBID Assessment Budget

The following table outlines the CCBID maximum budget for 2027.

EXPENDITURES	Zone1	Zone 2	Zone 3	TOTAL BUDGET	% of Budget
Clean, Safe and Beautiful	\$2,011,595.26	\$503,293.46	\$585,111.28	\$3,100,000.00	81.58%
Management	\$454,231.19	\$113,646.91	\$132,121.90	\$700,000.00	18.42%
Total Expenditures	\$2,465,826.44	\$616,940.37	\$717,233.18	\$3,800,000.00	100.00%
REVENUES					
Assessment Revenues	\$2,391,851.65	\$598,432.16	\$695,716.19	\$3,686,000.00	97.00%
Other Revenues (1)	\$73,974.79	\$18,508.21	\$21,517.00	\$114,000.00	3.00%
Total Revenues	\$2,465,826.44	\$616,940.37	\$717,233.18	\$3,800,000.00	100.00%

(1) Other non-assessment funding to cover the cost associated with general benefit.

Budget Adjustments

During the 10-year term annual assessments may increase up to 10% to take into consideration the increase in program costs as well as the increased cost of activities once the Metro station opens in late 2026. Assessment budgets may also increase based on development in the CCBID. The determination of annual adjustments in assessment rates will be subject to the review and approval of the CCBID Owners' Association. The CCBID Owners' Association will develop annual budgets and service programs each year.

The table below illustrates the estimated maximum budget for each year of the CCBID based on the maximum percentage increase. All figures have been rounded to the nearest dollar.

	2027	2028	2029	2030	2031
Clean, Safe and Beautiful	\$3,100,000	\$3,410,000	\$3,751,000	\$4,126,100	\$4,538,710
Management	\$700,000	\$770,000	\$847,000	\$931,700	\$1,024,870
TOTAL BUDGET	\$3,800,000	\$4,180,000	\$4,598,000	\$5,057,800	\$5,563,580
Assessment Revenues	\$3,686,000	\$4,054,600	\$4,460,060	\$4,906,066	\$5,396,673
Other Revenues	\$114,000	\$125,400	\$137,940	\$151,734	\$166,907
TOTAL REVENUES	\$3,800,000	\$4,180,000	\$4,598,000	\$5,057,800	\$5,563,580
	2032	2033	2034	2035	2036
Clean, Safe and Beautiful	\$4,992,581	\$5,491,839	\$6,041,023	\$6,645,125	\$7,309,638
Management	\$1,127,357	\$1,240,093	\$1,364,102	\$1,500,512	\$1,650,563
TOTAL BUDGET	\$6,119,938	\$6,731,932	\$7,405,125	\$8,145,637	\$8,960,201
Assessment Revenues	\$5,936,340	\$6,529,974	\$7,182,971	\$7,901,268	\$8,691,395
Other Revenues	\$183,598	\$201,958	\$222,154	\$244,369	\$268,806
TOTAL REVENUES	\$6,119,938	\$6,731,932	\$7,405,125	\$8,145,637	\$8,960,201

Any accrued interest or delinquent payments will be expended in the above categories.

The cost of CCBID improvements and activities may vary in any given year depending on market conditions and the cost of providing those services. Expenditures for each of the line items may be adjusted up or down 10% between them to continue the same level of service. The Owners' Association Board of Directors shall make such determination. In addition, any annual budget surplus, including those created through cost saving measures, unexpected reductions in expenses or unanticipated increases to income, will be rolled into the following year's budget. The carryover funds will be applied to the same budget line item as the line item that was the source of the carryover funds. The budget will be adjusted accordingly consistent with the Management District Plan to adjust for surpluses that are carried forward to ensure that the CCBID is spending these funds in a timely manner and is complying with applicable State laws and City policies. Any change in line-item expenditures and/or budget surplus will be approved by the Owners' Association Board of Directors and submitted in the annual report, pursuant to Section 36650 of the State Law.

CCBID Renewal

CCBID funds, which may consist of rollover funds may be used for renewing the district. The CCBID will have a 10-year term beginning January 1, 2027, through December 31, 2036. If the CCBID is not renewed again at the end of the proposed 10-year renewal term, services will end on December 31, 2036.

Bond Issuance

No bonds will be issued to finance improvements.

SECTION 5: ASSESSMENT METHODOLOGY

General

This Management District Plan provides for the levy of assessments for the purpose of providing improvements and activities that specially benefit real property in the CCBID. These assessments are not taxes for the general benefit of the City but are assessments that convey special benefits to each individual assessed parcel for which the improvements and activities are provided.

Land Use Considerations

Each assessed parcel within the CCBID specially benefits from the CCBID activities but not to the same degree. The proportional special benefit and assessment methodology provides the following land use considerations for the MTA Layover parcel and parking structures:

- **MTA Layover Parcel:** The Metropolitan Transit Authority (MTA) owns and operates a public transit layover area within the CCBID boundaries at the corner of Constellation Avenue and Century Park West (APN 4319-004-142). This is a public transit layover parcel for MTA buses. This area is for MTA vehicles only and it is not intended for public access and does not benefit from any business activity. Its use is not commerce driven and is not consistent with other uses in the CCBID. No services will be provided to this parcel as there is very little pedestrian traffic, only the bus drivers are allowed on the parcel. Therefore, it is deemed not to benefit from the CCBID services, and thus will not be assessed.
- **Parking Structures:** Depending on usage and ownership, parking structures vary in their demand for CCBID services. Parking structures will be assessed at a rate commensurate with the special benefit received and all parking structures will pay 100% of the special benefits it receives from the CCBID services. Parking structures will be subject to one of the following methodologies:
 - a. Integrated parking structures (i.e., those that are integrated within and/or dedicated to other buildings that have primary uses other than parking and are also under the same ownership as the other buildings) do not receive special benefits from the CCBID improvements and activities. These structures are not intended for commercial operation use and mostly do not contribute to an attraction of business or an increase in pedestrian traffic. Thus, the total building square footage allocated to a parcel that contains a building plus an integrated parking structure will be reduced by building square footage allocated to the integrated parking structure.
 - b. All other parking structures (i.e., stand-alone parking structures that are not ancillary to a building) will specially benefit from the CCBID improvements and activities as these structures generate pedestrian traffic that may distribute throughout the CCBID. Non-integrated structured parking, with separate ownership, because of its commercial nature and diversity of users requires the same level of CCBID services and receives the same special benefits as all other assessed parcels in the CCBID and will be assessed accordingly for its building square footage.

Change in Land Use: If at any time a parcel changes its land use that parcel then will be subject to the assessment methodology for the new land use. As a result, the CCBID may experience the addition or subtraction of assessable lot or building square footage for parcels included and assessed within the CCBID boundaries. The modification of land use of assessed parcels within the CCBID may then change upwards or downwards the amount of total lot and building square footage assessment for these parcels. In future years, the assessments for the special benefits bestowed upon individual assessed parcels may change in accordance with the assessment methodology formula listed in the Management District Plan and Engineer's Report, provided the assessment formula does not change.

Assessment Factors

The methodology to levy assessments upon real property that receives special benefits from the CCBID improvements and activities is building square footage for developed parcels and lot square footage for vacant parcels. These land use factors are an equitable way to identify the proportional special benefit that each of the assessed parcels receive. Building square footage for developed parcels is relevant to the current use of a property and is also closely correlated to the potential pedestrian traffic from each developed parcel and the demand developed parcels have for the CCBID activities, whereas a vacant parcel's lot square footage reflects the long-term value implications of the improvement district. Together, these land use factors serve as the basic unit of measure to calculate how much special benefit each parcel receives in relationship to the district as a whole. This is the basis then to proportionately allocate the cost of the special benefits to each assessed parcel.

The CCBID improvements and activities are designed to provide special benefits to the mix of land uses found within the district, i.e. commercial, office, retail, residential, and publicly owned. Each parcel's building square footage or lot square footage is the best unit of measure to convey the special benefits of the CCBID services, as the intent of these services is to improve the safety and cleanliness of each individual parcel, to increase building occupancy and lease rates, to encourage new business development and attract ancillary businesses and services for parcels within the CCBID. The most equitable way to determine each parcel's proportionate special benefit from the CCBID services is to relate each individual parcel's Building Square Footage or Lot Square Footage to the Building Square Footage or Lot Square Footage of all other parcels in the CCBID.

Building square footage is defined as the total building square footage as determined by the outside measurements of a building. The gross building square footage is taken from the County of Assessor's records.

Lot square footage is defined as the total amount of area within the boundaries of the parcel. The boundaries of a parcel are defined on the County Assessor parcel maps.

Each one of these land use factors represents the Benefit Units allocated to each specially benefitted parcel. The total number of assessable Benefit Units in the CCBID by Benefit Zone are:

Benefit Zone	Benefit Units
Zone 1	7,148,352
Zone 2	2,974,322
Zone 3	8,298,820

The number of Benefit Units for each assessed parcel within the CCBID was determined from data collected from the Los Angeles County Assessor's Office and verified by the City Clerk's office.

Assessment Methodology

The proportionate special benefit each assessed parcel receives shall be determined in relationship to the entirety of the capital cost of the CCBID improvements and activities as identified in Section 5. Due to the proportionate special benefits received by these individual parcels from the CCBID services, these parcels will be assessed a rate which is proportionate to the amount of special benefits received. Only special benefits are assessable, and these benefits must be separated from any general benefits. As required by the State Constitution Article XIII D Section 4(a), the general benefits of an assessment district must be quantified and separated out so that the cost of the activities that are attributed to general benefit are deducted from the cost assessed against each specially benefitted parcel. General benefits are benefits from the CCBID activities and improvements that are not special in nature, are not "particular and distinct" and are not over and above the benefits that other parcels receive. The attached Engineer's Report has calculated that 3.0% of the CCBID activities may be general in nature and will be funded from sources other than special assessments, see the Engineer's Report for discussion of general and special benefits.

Calculation of Assessments

Based on the assessment factors, benefit units for each variable plus the proposed budget for each benefit zone, all of which are discussed above, the following table illustrates the maximum annual assessment per assessable benefit unit for per each benefit zone. Note, assessment rates are rounded off to the fourth decimal place and a parcel's assessment may vary slightly when calculated using the assessment rates below.

Benefit Zone	Assmt Rate per Benefit Unit
Zone 1:	\$0.3346
Zone 2:	\$0.2012
Zone 3:	\$0.0838

Specifically, the assessment rates for each benefit zone are calculated as follows:

Zone 1

The Zone 1 assessable budget divided by the number of Benefit Units in Zone 1.

$$\text{Assessable Budget} / \text{Benefit Units} \\ (\$2,391,851.65 / 7,148,352) = \$0.3346 \text{ per Benefit Unit}$$

Sample Parcel Assessment

The initial year assessment for a parcel with 100,000 building square feet or lot square feet (Benefit Units) is calculated as follows:

$$\text{Bldg square footage} \times \text{the assessment rate} (100,000 \times \$0.3346) = \$33,460.00$$

Zone 2

The Zone 2 assessable budget divided by the number of Benefit Units in Zone 2.

$$\begin{aligned} & \text{Assessable Budget / Benefit Units} \\ & (\$598,432.16 / 2,974,322) = \$0.2012 \text{ per Benefit Unit} \end{aligned}$$

Sample Parcel Assessment

The initial year assessment for a parcel with 100,000 building square feet or lot square feet (Benefit Units) is calculated as follows:

$$\text{Bldg square footage x the assessment rate (100,000 x \$0.2012) = \$21,120.00}$$

Zone 3

The Zone 3 assessable budget divided by the number of Benefit Units in Zone 3.

$$\begin{aligned} & \text{Assessable Budget / Benefit Units} \\ & (\$695,716.19 / 8,298,820) = \$0.0838 \text{ per Benefit Unit} \end{aligned}$$

Sample Parcel Assessment

The initial year assessment for a parcel with 100,000 building square feet (Benefit Units) is calculated as follows:

$$\text{Bldg square footage x the assessment rate (100,000 x \$0.0830) = \$8,380.00}$$

Public Parcel Assessments

There are 5 publicly owned parcels in the CCBID, all of which are identified as assessable and receive special benefit from the CCBID services. Of the 5 identified assessed parcels, 2 are owned by the City of Los Angeles, 1 by the Los Angeles County Metropolitan Transportation Authority, and 2 by the State of California Teachers Retirement.

All publicly owned parcels will pay their proportional share of costs based on the special benefits conferred to those individual parcels. Article XIID of the California Constitution was added in November 1996 and provides for these assessments. It specifically states in Section 4(a) that "Parcels within a district that are owned or used by any agency...shall not be exempt from assessment unless the agency can demonstrate by clear and convincing evidence that those publicly owned parcels in fact receive no special benefit." Below is a list of the publicly owned parcels and their respective assessments.

APN	OWNER NAME	SITE ADDRESS	BENEFIT ZONE	2027 Assmt	%
4319-003-901	L A City	Santa Monica median	Zone 3	\$5,665.02	0.15%
4319-003-902	L A City	Santa Monica median	Zone 3	\$990.07	0.03%
				\$6,655.09	0.18%
4319-001-905	LACTMA	1940 Century Park E	Zone 3	\$2,515.83	0.07%
4319-001-903	State Of Ca Teachers Retirement	1800 Century Park E	Zone 3	\$20,954.26	0.57%
4319-001-904	State Of Ca Teachers Retirement	1840 Century Park E	Zone 3	\$28,415.50	0.77%
				\$49,369.76	1.34%

Annual Assessment Adjustments

During the 10-year term annual assessments may increase up to 10% to take into consideration the increase in program costs as well as the increased cost of activities once the Metro station opens in late 2026. Assessment budgets may also increase based on development in the CCBID. The determination of annual adjustments in assessment rates will be subject to the review and approval of the CCBID Owners' Association. The CCBID Owners' Association will develop annual budgets and service programs each year.

The table below illustrates the estimated maximum assessments (rounded to four decimal places) for each year of the CCBID based on the estimated percentage increase as discussed above.

Benefit Zone	Maximum Assessment Rate				
	2027	2028	2029	2030	2031
Zone 1:	\$0.3346	\$0.3681	\$0.4049	\$0.4454	\$0.4899
Zone 2:	\$0.2012	\$0.2213	\$0.2435	\$0.2678	\$0.2946
Zone 3	\$0.0838	\$0.0922	\$0.1014	\$0.1116	\$0.1227
	2032	2033	2034	2035	2036
Zone 1:	\$0.5389	\$0.5928	\$0.6520	\$0.7172	\$0.7890
Zone 2:	\$0.3240	\$0.3564	\$0.3921	\$0.4313	\$0.4744
Zone 3	\$0.1350	\$0.1485	\$0.1634	\$0.1797	\$0.1977

CCBID Guidelines

Time and Manner for Collecting Assessments

As provided by State Law, the CCBID assessment will appear as a separate line item on annual property tax bills prepared and issued by the County of Los Angeles. Assessments shall be collected at the same time and in the same manner as ad valorem taxes paid to the County of Los Angeles. CCBID assessments shall provide for the same lien priority and penalties for delinquent payment as is provided for ad valorem property taxes. Any delinquent assessments owed for the first year will be added to the property tax roll for the following year as delinquent. Property owner means any person shown as the owner/taxpayer on the last equalized assessment roll or otherwise known to be the owner/taxpayer by the County. The City of Los Angeles is authorized to collect any assessments not placed on the County tax rolls, or to place

assessments, unpaid delinquent assessments, or penalties on the County tax rolls as appropriate to implement this Plan and the Assessment Engineer's Report.

Disestablishment

State law provides for the disestablishment of a CCBID pursuant to an annual process. The 30-day period begins each year on the anniversary day that the City Council first establishes the CCBID. Within this annual 30-day period, if the owners of real property who pay more than 40% of the assessments levied submit a written petition for disestablishment, the CCBID may be dissolved by the City Council. The City Council must hold a public hearing on the proposed disestablishment before voting on whether to disestablish the CCBID.

Duration

The CCBID will have a 10-year term commencing January 1, 2027, through December 31, 2036. Any major modifications or new or increased assessments during the term of the CCBID that are not consistent with the provisions of original Management District Plan will require a new mail ballot process.

Future Development

As a result of continued development, the CCBID may experience the addition or subtraction of assessable footage for parcels included and assessed within the CCBID boundaries. The modification for parcel improvements within the CCBID, which changes upwards or downwards the amount of total assessable footage for these parcels will, pursuant to Government Code 53750, be prorated to the date they receive the temporary and/or permanent certificate of occupancy and will be billed directly by the City for the prorated year. Parcels that experience a loss of building square footage need to provide notice of the change to the District by April 1st of each year. Any delinquent assessments owed for the modification of assessable footage that was billed directly by the City will be added to the property tax roll for the following year as delinquent.

Implementation Timeline

The Century City BID is expected to be renewed by June 2026 for inclusion of parcel assessments on the County of Los Angeles 2026 tax roll with an implementation date of the Management District Plan on January 1, 2027. Consistent with State law, the CCBID will have a 10-year life through December 31, 2036.

Task	Timeline
Stakeholder outreach Identify service priorities and budgets	June – August 2025
Draft Management District Plan and Engineer's Report	September 2025
City Review	October – December 2025
Final Management District Plan and Engineer's Report	December 2025
Petition Drive	January - March 2026
City Council, Resolution of Intention	May 2026
Assessment Ballots	May – June 2026
City Council public hearing, Resolution of Formation	July 2026
Renewed CCBID services begin	January 2027

SECTION 6: CCBID GOVERNANCE

City Council

Following the submission of petitions from property owners representing more than 50% of the assessments to be paid, the City Council, upon holding a public hearing on the proposed CCBID, may elect to renew the CCBID. The CCBID is renewed by a City Council resolution, including the levy of an assessment on property, if the assessment is first approved by parcel owners in a balloting process.

CCBID Governance

Consistent with Business Assessment District legislation throughout the nation, California's "Property and Business Assessment District Law of 1994" establishes a governance framework that allows property owners who pay assessments the ability to determine how the assessments are used. This Management District Plan may be subject to changes if required by the state of California or the City of Los Angeles.

The CCBID shall continue to contract with a nonprofit organization that acts as the Owners' Association and governing board for the CCBID. The role of the Owners' Association is consistent with similar CCBIDs and management organizations throughout California and the nation. The Owners' Association determines budgets, assessment adjustments and monitors service delivery. As part of the Management Plan, the nonprofit organization oversees the delivery of day-to-day CCBID activities. The CCBID Owners' Association Board of Directors will represent a cross section of property owners found throughout the district.

Brown Act & Public Records Act Compliance

The Owners' Association is subject to government regulations relating to transparency, namely the Ralph M. Brown Act and the California Public Records Act. These regulations are designed to promote public accountability. The Owners' Association must act as a legislative body under the Ralph M. Brown Act (Government Code §54950 et seq.). Thus, meetings of the Board of Directors of the Owners' Association and certain committees must be held in compliance with the public notice and other requirements of the Brown Act. The Owners' Association is also subject to the record keeping and disclosure requirements of the California Public Records Act.

Annual Report

The Owners' Association shall present an annual report at the end of each year of operation to the City Council pursuant to Streets and Highways Code §36650. The annual report is a prospective report for the upcoming year and must include:

1. Any proposed changes in the boundaries of the PBID or in any benefit zones or classification of property within the district;
2. The improvements, maintenance, and activities to be provided for that fiscal year;
3. The estimated cost of providing the improvements, maintenance, and activities to be provided for that fiscal year;
4. The method and basis of levying the assessment in sufficient detail to allow each real property owner to estimate the amount of the assessment to be levied against his or her property for that fiscal year;
5. The estimated amount of any surplus or deficit revenues to be carried over from a previous fiscal year; and
6. The estimated amount of any contributions to be made from sources other than assessments levied pursuant to this Plan.

SECTION 7: ASSESSMENT ROLL

The total assessment amount for calendar year 2027 is \$3,686,000 apportioned to each individual assessed parcel, as follows.

APN	OWNER NAME	SITE ADDRESS	BENEFIT ZONE	PARCEL ASSMT
4319-002-057	10100 Santa Monica Inc	10100 Santa Monica Blvd	Zone 3	\$54,925.30
4319-002-060	1875 1925 Century Park East Co	1875 Century Park E	Zone 3	\$77,796.57
4319-003-065	1999 Stars LLC	1999 Avenue Of The Stars	Zone 1	\$281,107.03
4319-004-140	Ap Properties Ltd	10250 Constellation Blvd	Zone 3	\$67,789.66
4319-004-141	Ap Properties Ltd	10250 Constellation Blvd	Zone 3	\$5,811.18
4319-004-142	Ap Properties Ltd		Zone 3	\$1,736.27
4319-001-008	Automobile Club Of So Calif	1950 Century Park E	Zone 3	\$2,076.80
4319-004-143	Avenue Of The Stars Associates		Zone 1	\$0.00
4319-004-146	Avenue Of The Stars Associates		Zone 1	\$0.00
4319-001-013	Cc Plant Fee LLC	2052 Century Park E	Zone 3	\$1,420.13
4319-001-009	Cc Site One LLC		Zone 3	\$1,497.26
4319-001-010	Cc Site One LLC	2010 Century Park E	Zone 3	\$5,039.46
4319-002-063	Cc Site Two LLC		Zone 1	\$293,624.15
4319-004-160	Century City Garage Partners LP		Zone 3	\$7,925.48
4319-003-063	Century City Mall LLC	1930 Century Park W	Zone 3	\$15,444.58
4319-003-083	Century City Mall LLC	10250 Santa Monica Blvd	Zone 2	\$292,815.32
4319-001-014	Century City Med Pz Lnd Co	2070 Century Park E	Zone 3	\$27,725.38
4319-001-005	Century Park	1880 Century Park E	Zone 3	\$28,814.46
4319-002-045	Douglas Emmett 1997 LLC	1801 Century Park E	Zone 3	\$31,899.77
4319-003-055	Douglas Emmett 20ii LLC	1901 Avenue Of The Stars	Zone 1	\$163,222.12
4319-002-046	Duesenberg Investment Co	1800 Avenue Of The Stars #1400	Zone 1	\$101,233.78
4319-002-056	Duesenberg Investment Company	1900 Avenue Of The Stars #156	Zone 1	\$209,337.28
4319-016-033	Entertainment Center LLC	2040 Avenue Of The Stars	Zone 1	\$256,665.70
4315-019-005	Fox Plaza LLC	2121 Avenue Of The Stars	Zone 1	\$266,021.50
4315-019-013	Fox Studio Lot LLC	10201 W Pico Blvd #111	Zone 2	\$305,616.84
4319-001-006	Fsp 1888 Century Park East LLC	1888 Century Park E	Zone 3	\$44,344.05
4319-003-901	L A City	Santa Monica median	Zone 3	\$5,665.02
4319-003-902	L A City	Santa Monica median	Zone 3	\$990.07
4319-001-905	LACTMA	1940 Century Park E	Zone 3	\$2,515.83
4319-004-163	Next Century Partners LLC	2025 Avenue Of The Stars	Zone 1	\$269,016.19
4319-016-029	One Hundred Towers LLC	2029 Century Park E	Zone 3	\$102,829.57
4319-016-030	One Hundred Towers LLC	2049 Century Park E #260	Zone 3	\$103,334.83
4319-001-803	Pacific Bell		Zone 3	\$5,806.45
4319-001-002	Sm 10000 Property LLC		Zone 3	\$896.68
4319-001-015	Sm 10000 Property LLC	10000 Santa Monica Blvd	Zone 3	\$50,061.63
4319-001-903	State Of Ca Teachers Retirement	1800 Century Park E	Zone 3	\$20,954.26
4319-001-904	State Of Ca Teachers Retirement	1840 Century Park E	Zone 3	\$28,415.50
4315-019-006	Sumitomo Realty & Development	2151 Avenue Of The Stars	Zone 1	\$112,873.24
4319-017-022	Michael And Nancy Sitrick Trust	1 W Century Dr #THA	Zone 1	\$2,014.30
4319-017-023	E J Debartolo Jr Dynasty Trust	1 W Century Dr #THB	Zone 1	\$2,258.56

APN	OWNER NAME	SITE ADDRESS	BENEFIT ZONE	PARCEL ASSMT
4319-017-024	Kashanian Family Trust	1 W Century Dr #3a	Zone 1	\$1,525.78
4319-017-025	Efp Trust	1 W Century Dr #3b	Zone 1	\$1,147.68
4319-017-026	Barry Richard A Tr	1 W Century Dr #3c	Zone 1	\$930.19
4319-017-027	Barry Nancy Tr Nancy Barry Tru	1 W Century Dr #3d	Zone 1	\$826.47
4319-017-028	Dmr Cc Properties Llc	1 W Century Dr #4a	Zone 1	\$1,559.24
4319-017-029	E Subelman & M Selz Trust	1 W Century Dr #4b	Zone 1	\$1,151.03
4319-017-030	Logan Renee Tr	1 W Century Dr #4c	Zone 1	\$933.54
4319-017-031	Susan Gottlieb Trust	1 W Century Dr #4d	Zone 1	\$819.77
4319-017-032	Del Family Trust	1 W Century Dr #5a	Zone 1	\$1,525.78
4319-017-033	Schwimer	1 W Century Dr #5b	Zone 1	\$1,147.68
4319-017-034	Ricky Seung Trust	1 W Century Dr #5c	Zone 1	\$930.19
4319-017-035	Koenig Legacy Llc	1 W Century Dr #5d	Zone 1	\$826.47
4319-017-038	Hemus Junko Tr	1 W Century Dr #6c	Zone 1	\$933.54
4319-017-039	One Century Drive 6d Llc	1 W Century Dr #6d	Zone 1	\$819.77
4319-017-040	Arzak Properties Llc	1 W Century Dr #7a	Zone 1	\$1,525.78
4319-017-041	Cole Trust	1 W Century Dr #7b	Zone 1	\$1,147.68
4319-017-042	Brenda J Abramson Trust	1 W Century Dr #7c	Zone 1	\$930.19
4319-017-043	Remo Onda & Julia Widjaja	1 W Century Dr #7d	Zone 1	\$826.47
4319-017-044	Sung Min	1 W Century Dr #8a	Zone 1	\$1,559.24
4319-017-045	Calla Tartikoff Trust	1 W Century Dr #8b	Zone 1	\$1,151.03
4319-017-046	Harmony Fortune Holdings Limit	1 W Century Dr #8c	Zone 1	\$933.54
4319-017-047	Charlie Lee Llc	1 W Century Dr #8d	Zone 1	\$819.77
4319-017-048	Cheng Family Trust	1 W Century Dr #9a	Zone 1	\$1,525.78
4319-017-049	Tcc Llc	1 W Century Dr #9b	Zone 1	\$1,147.68
4319-017-050	Cronrod Family Trust	1 W Century Dr #9c	Zone 1	\$930.19
4319-017-051	David Alden & Dina Sabah	1 W Century Dr #9d	Zone 1	\$826.47
4319-017-052	Tamim Family Trust	1 W Century Dr #10a	Zone 1	\$1,559.24
4319-017-053	Richard & Susan Shemin Trust	1 W Century Dr #10b	Zone 1	\$1,151.03
4319-017-054	Fingold Malka Tr	1 W Century Dr #10c	Zone 1	\$933.54
4319-017-055	Charlie Lee Llc	1 W Century Dr #10d	Zone 1	\$819.77
4319-017-056	Kamyar Mahboubi Fardi & Uria Mahboubi	1 W Century Dr #11a	Zone 1	\$1,174.45
4319-017-057	Peltz Claudia Tr	1 W Century Dr #11b	Zone 1	\$1,177.80
4319-017-058	The Danielle Del Separate Trus	1 W Century Dr #11c	Zone 1	\$1,097.49
4319-017-059	Frank Maiorano Living Trust	1 W Century Dr #11d	Zone 1	\$836.50
4319-017-060	Drabinsky Family Trust	1 W Century Dr #12a	Zone 1	\$1,174.45
4319-017-061	Berkley Jeffrey Tr	1 W Century Dr #12b	Zone 1	\$1,177.80
4319-017-062	Reseda Investments Limited	1 W Century Dr #12c	Zone 1	\$1,177.80
4319-017-063	Michael Mendelson	1 W Century Dr #12d	Zone 1	\$836.50
4319-017-064	Wilshire Palm Llc	1 W Century Dr #14a	Zone 1	\$1,174.45
4319-017-065	Teshinsky Family Trust	1 W Century Dr #14b	Zone 1	\$1,177.80
4319-017-066	Fogelman Family Trust	1 W Century Dr #14c	Zone 1	\$1,097.49
4319-017-067	A Griffith & D Elias Trust	1 W Century Dr #14d	Zone 1	\$836.50
4319-017-068	Akkad Sooha Nasouh Tr	1 W Century Dr #15a	Zone 1	\$1,174.45
4319-017-069	Sw Century Holdings Llc	1 W Century Dr #15b	Zone 1	\$1,177.80

APN	OWNER NAME	SITE ADDRESS	BENEFIT ZONE	PARCEL ASSMT
4319-017-070	Tjs Holdings Llc	1 W Century Dr #15c	Zone 1	\$1,097.49
4319-017-071	Duta Holdings Llc	1 W Century Dr #15d	Zone 1	\$836.50
4319-017-072	Patricia L Rosenthale Trust	1 W Century Dr #16a	Zone 1	\$1,174.45
4319-017-073	Sixteenth The Century Llc	1 W Century Dr #16b	Zone 1	\$1,177.80
4319-017-074	Ahad Aghaj & Akhtar Siadati	1 W Century Dr #16c	Zone 1	\$1,097.49
4319-017-075	1 West Century Trust	1 W Century Dr #16d	Zone 1	\$836.50
4319-017-076	Stephanie Lo & Carl Moy	1 W Century Dr #17a	Zone 1	\$1,174.45
4319-017-077	Sasiela Legacy Trust	1 W Century Dr #17b	Zone 1	\$1,177.80
4319-017-078	Evelyn Furtak-Dorfman Trust	1 W Century Dr #17c	Zone 1	\$1,097.49
4319-017-079	Sarah Soewatdy	1 W Century Dr #17d	Zone 1	\$836.50
4319-017-080	Hamedan Llc	1 W Century Dr #18a	Zone 1	\$1,174.45
4319-017-081	Century 18la Llc	1 W Century Dr #18b	Zone 1	\$1,177.80
4319-017-082	Transmega Ca Holding Llc	1 W Century Dr #18c	Zone 1	\$1,097.49
4319-017-083	Hou Polyn C Tr	1 W Century Dr #18d	Zone 1	\$836.50
4319-017-084	Lee 1996 Trust	1 W Century Dr #19a	Zone 1	\$1,174.45
4319-017-085	Bernard & Maxine Lynn Trust	1 W Century Dr #19b	Zone 1	\$1,177.80
4319-017-086	Jonathan Tahir	1 W Century Dr #19c	Zone 1	\$1,097.49
4319-017-087	Margaurita Management Llc	1 W Century Dr #19d	Zone 1	\$836.50
4319-017-088	Harrmax5 Llc	1 W Century Dr #20a	Zone 1	\$1,177.80
4319-017-089	Roberta Bogen Revocable Trust	1 W Century Dr #20b	Zone 1	\$1,191.18
4319-017-090	Weiss Family Trust	1 W Century Dr #20c	Zone 1	\$1,087.46
4319-017-091	Ca Century Trust	1 W Century Dr #20d	Zone 1	\$843.20
4319-017-092	Millet Trust &	1 W Century Dr #21a	Zone 1	\$1,177.80
4319-017-093	Cameron Kim	1 W Century Dr #21b	Zone 1	\$1,191.18
4319-017-094	Ribner Family Trust	1 W Century Dr #21c	Zone 1	\$1,087.46
4319-017-095	Kenneth & Helen Park	1 W Century Dr #21d	Zone 1	\$843.20
4319-017-096	1 West Century Drive Llc	1 W Century Dr #22a	Zone 1	\$1,177.80
4319-017-097	Carol H Goldsmith Trust	1 W Century Dr #22b	Zone 1	\$1,191.18
4319-017-098	Northcoast Place Llc	1 W Century Dr #22c	Zone 1	\$1,087.46
4319-017-099	Hironobu Sakaguchi Trust	1 W Century Dr #22d	Zone 1	\$843.20
4319-017-100	Wagman Family Trust	1 W Century Dr #23a	Zone 1	\$1,177.80
4319-017-101	Arshia Refoua	1 W Century Dr #23b	Zone 1	\$1,191.18
4319-017-102	Jamita Trust	1 W Century Dr #23c	Zone 1	\$1,087.46
4319-017-103	Wagman Family Trust	1 W Century Dr #23d	Zone 1	\$843.20
4319-017-104	Lili Gai	1 W Century Dr #24a	Zone 1	\$1,177.80
4319-017-105	Skyra Century Llc	1 W Century Dr #24b	Zone 1	\$1,191.18
4319-017-106	One West Century Llc	1 W Century Dr #24c	Zone 1	\$1,087.46
4319-017-107	Lili Gai	1 W Century Dr #24d	Zone 1	\$843.20
4319-017-108	Holden Stuart & Toni K Trs	1 W Century Dr #25a	Zone 1	\$1,177.80
4319-017-109	Dickson Susan K Tr	1 W Century Dr #25b	Zone 1	\$1,191.18
4319-017-110	Holmes Family Trust	1 W Century Dr #25c	Zone 1	\$1,087.46
4319-017-111	Jaeyoul Choi	1 W Century Dr #25d	Zone 1	\$843.20
4319-017-112	Kathleen Harouche	1 W Century Dr #26a	Zone 1	\$1,177.80
4319-017-113	Trust Agreement No Y-3	1 W Century Dr #26b	Zone 1	\$1,221.30
4319-017-114	Yeechin Shiong 2019 Trust	1 W Century Dr #26c	Zone 1	\$1,087.46

APN	OWNER NAME	SITE ADDRESS	BENEFIT ZONE	PARCEL ASSMT
4319-017-115	Richard And Susan Shemin Family Trust	1 W Century Dr #26d	Zone 1	\$843.20
4319-017-116	Gindi Elie J Trs	1 W Century Dr #27a	Zone 1	\$1,177.80
4319-017-117	Century Drive Trust	1 W Century Dr #27b	Zone 1	\$1,191.18
4319-017-118	Michael Fowler	1 W Century Dr #27c	Zone 1	\$1,087.46
4319-017-119	Mahasen Yasin	1 W Century Dr #27d	Zone 1	\$843.20
4319-017-120	Gary & Chris Marks Trust	1 W Century Dr #28a	Zone 1	\$1,488.98
4319-017-121	Pearl Trust	1 W Century Dr #28b	Zone 1	\$1,147.68
4319-017-122	Century Drive Llc	1 W Century Dr #28c	Zone 1	\$913.46
4319-017-123	Vieste Investments Llc	1 W Century Dr #28d	Zone 1	\$752.85
4319-017-124	Michael Mendelson	1 W Century Dr #29a	Zone 1	\$1,488.98
4319-017-125	Jimc Holdings Llc	1 W Century Dr #29b	Zone 1	\$1,147.68
4319-017-126	The Malka Fingold Revocable Tr	1 W Century Dr #29c	Zone 1	\$913.46
4319-017-127	Henry Setiawan & Goe Ling	1 W Century Dr #29d	Zone 1	\$752.85
4319-017-128	William M Dorfman Trust	1 W Century Dr #30a	Zone 1	\$1,488.98
4319-017-129	Matsuhisa N Tr Matsuhisa Trust	1 W Century Dr #30b	Zone 1	\$1,147.68
4319-017-130	Daniel Lee	1 W Century Dr #30c	Zone 1	\$913.46
4319-017-131	Paul Mir Trust	1 W Century Dr #30d	Zone 1	\$752.85
4319-017-132	Gleicher Trust	1 W Century Dr #31a	Zone 1	\$1,488.98
4319-017-133	Bh Palm Drive Llc	1 W Century Dr #31b	Zone 1	\$1,147.68
4319-017-134	Hundert Trust	1 W Century Dr #31c	Zone 1	\$913.46
4319-017-135	Hamad Neama	1 W Century Dr #31d	Zone 1	\$752.85
4319-017-136	Gleicher Trust	1 W Century Dr #32a	Zone 1	\$1,488.98
4319-017-137	Yaira La Llc	1 W Century Dr #32b	Zone 1	\$1,147.68
4319-017-138	Golden Incorpra Enterprise Llc	1 W Century Dr #32c	Zone 1	\$913.46
4319-017-139	Wen Wang & Long Ling	1 W Century Dr #32d	Zone 1	\$752.85
4319-017-140	Ben	1 W Century Dr #33a	Zone 1	\$1,488.98
4319-017-141	Mirvis Bypass Trust	1 W Century Dr #33b	Zone 1	\$1,147.68
4319-017-142	Goodman Mark Co Tr	1 W Century Dr #33c	Zone 1	\$913.46
4319-017-143	Bronte Trust	1 W Century Dr #33d	Zone 1	\$752.85
4319-017-144	34a One Century Llc	1 W Century Dr #34a	Zone 1	\$1,488.98
4319-017-145	Dayle Weiner Trust	1 W Century Dr #34b	Zone 1	\$1,147.68
4319-017-146	Rascoff Family Trust	1 W Century Dr #34c	Zone 1	\$913.46
4319-017-147	Syb Family Trust	1 W Century Dr #34d	Zone 1	\$752.85
4319-017-148	Nk Real Estate Investments Llc	1 W Century Dr #35a	Zone 1	\$1,488.98
4319-017-149	Silco Enterprises Llc	1 W Century Dr #35b	Zone 1	\$1,147.68
4319-017-150	Cmash Llc	1 W Century Dr #35c	Zone 1	\$913.46
4319-017-151	Schmidtengasse Llc	1 W Century Dr #35d	Zone 1	\$752.85
4319-017-152	Beverly Park Trust	1 W Century Dr #36PHA	Zone 1	\$2,034.38
4319-017-153	Accordion Investments Llc	1 W Century Dr #36PHB	Zone 1	\$2,067.84
4319-017-154	Jonathan Woetzel	1 W Century Dr #37PHA	Zone 1	\$1,873.77
4319-017-155	Brian Delamarter	1 W Century Dr #37PHB	Zone 1	\$1,927.31
4319-017-156	Dubrow Family Trust	1 W Century Dr #38PHA	Zone 1	\$1,746.62
4319-017-157	Haas Family Trust	1 W Century Dr #38PHB	Zone 1	\$1,780.08
4319-017-158	Miriam Schaeffer Family Trust	1 W Century Dr #39PH	Zone 1	\$3,151.95

APN	OWNER NAME	SITE ADDRESS	BENEFIT ZONE	PARCEL ASSMT
4319-017-159	Century Ph 40 Llc	1 W Century Dr #40PH	Zone 1	\$3,108.45
4319-017-160	Cs Trust Of 2008	1 W Century Dr #41PHA	Zone 1	\$2,964.57
4319-017-161	Cs Trust Of 2008	1 W Century Dr #41PHB	Zone 1	\$3,044.88
4319-017-164	Cp Propco Llc	2025 Avenue Of The Stars #201	Zone 1	\$444.69
4319-017-165	Cp Propco Llc	2025 Avenue Of The Stars #202	Zone 1	\$320.55
4319-017-166	Cp Propco Llc	2025 Avenue Of The Stars #203	Zone 1	\$453.39
4319-017-167	Cp Propco Llc	2025 Avenue Of The Stars #204	Zone 1	\$396.17
4319-017-168	Cp Propco Llc	2025 Avenue Of The Stars #203	Zone 1	\$491.53
4319-017-169	Lisa H Meyer Trust	2025 Avenue Of The Stars #204	Zone 1	\$445.02
4319-017-170	Cp Propco Llc	2025 Avenue Of The Stars #205	Zone 1	\$334.60
4319-017-171	Cp Propco Llc	2025 Avenue Of The Stars #206	Zone 1	\$514.28
4319-017-172	Cp Propco Llc	2025 Avenue Of The Stars #207	Zone 1	\$520.31
4319-017-173	Bernard Khalili	2025 Avenue Of The Stars #208	Zone 1	\$259.65
4319-017-174	Cp Propco Llc	2025 Avenue Of The Stars #1201	Zone 1	\$856.58
4319-017-175	Neal Blitz	2025 Avenue Of The Stars #1202	Zone 1	\$515.96
4319-017-176	Cp Propco Llc	2025 Avenue Of The Stars #1203	Zone 1	\$649.80
4319-017-177	Cp Propco Llc	2025 Avenue Of The Stars #1204	Zone 1	\$776.28
4319-017-178	Cp Propco Llc	2025 Avenue Of The Stars #1205	Zone 1	\$516.29
4319-017-179	Cp Propco Llc	2025 Avenue Of The Stars #1206	Zone 1	\$517.29
4319-017-180	Cp Propco Llc	2025 Avenue Of The Stars #1207	Zone 1	\$516.29
4319-017-181	Cp Propco Llc	2025 Avenue Of The Stars #1208	Zone 1	\$516.63
4319-017-182	Cp Propco Llc	2025 Avenue Of The Stars #1209	Zone 1	\$514.95
4319-017-183	Cp Propco Llc	2025 Avenue Of The Stars #1210	Zone 1	\$515.62
4319-017-184	Cp Propco Llc	2025 Avenue Of The Stars #1211	Zone 1	\$853.23
4319-017-185	Cp Propco Llc	2025 Avenue Of The Stars #1212	Zone 1	\$805.72
4319-017-186	Cp Propco Llc	2025 Avenue Of The Stars #1213	Zone 1	\$819.77
4319-017-187	Cp Propco Llc	2025 Avenue Of The Stars #1214	Zone 1	\$821.78
4319-017-188	Cp Propco Llc	2025 Avenue Of The Stars #1215	Zone 1	\$820.44
4319-017-189	Cp Propco Llc	2025 Avenue Of The Stars #1216	Zone 1	\$819.77
4319-017-190	Cp Propco Llc	2025 Avenue Of The Stars #1217	Zone 1	\$819.77
4319-017-191	Cp Propco Llc	2025 Avenue Of The Stars #1218	Zone 1	\$908.11
4319-017-192	Cp Propco Llc	2025 Avenue Of The Stars #1219	Zone 1	\$907.44
4319-017-193	Cp Propco Llc	2025 Avenue Of The Stars #1220	Zone 1	\$820.44
4319-017-194	Cp Propco Llc	2025 Avenue Of The Stars #1221	Zone 1	\$802.04
4319-017-195	Century Stars Llc	2025 Avenue Of The Stars #1401	Zone 1	\$856.58
4319-017-196	Cp Propco Llc	2025 Avenue Of The Stars #1402	Zone 1	\$515.96
4319-017-197	Cp Propco Llc	2025 Avenue Of The Stars #1403	Zone 1	\$649.80
4319-017-198	Cp Propco Llc	2025 Avenue Of The Stars #1404	Zone 1	\$776.28
4319-017-199	Cp Propco Llc	2025 Avenue Of The Stars #1405	Zone 1	\$516.29
4319-017-200	Cp Propco Llc	2025 Avenue Of The Stars #1406	Zone 1	\$517.29
4319-017-201	Cp Propco Llc	2025 Avenue Of The Stars #1407	Zone 1	\$516.29
4319-017-202	Cp Propco Llc	2025 Avenue Of The Stars #1408	Zone 1	\$516.63
4319-017-203	Cp Propco Llc	2025 Avenue Of The Stars #1409	Zone 1	\$514.95
4319-017-204	Cp Propco Llc	2025 Avenue Of The Stars #1410	Zone 1	\$515.62
4319-017-205	Cp Propco Llc	2025 Avenue Of The Stars #1411	Zone 1	\$853.23

APN	OWNER NAME	SITE ADDRESS	BENEFIT ZONE	PARCEL ASSMT
4319-017-206	Cp Propco Llc	2025 Avenue Of The Stars #1412	Zone 1	\$805.72
4319-017-207	Cp Propco Llc	2025 Avenue Of The Stars #1413	Zone 1	\$819.77
4319-017-208	Cp Propco Llc	2025 Avenue Of The Stars #1414	Zone 1	\$821.78
4319-017-209	Cp Propco Llc	2025 Avenue Of The Stars #1415	Zone 1	\$820.44
4319-017-210	Cp Propco Llc	2025 Avenue Of The Stars #1416	Zone 1	\$819.77
4319-017-211	Cp Propco Llc	2025 Avenue Of The Stars #1417	Zone 1	\$819.77
4319-017-212	Cp Propco Llc	2025 Avenue Of The Stars #1418	Zone 1	\$908.11
4319-017-213	Cp Propco Llc	2025 Avenue Of The Stars #1419	Zone 1	\$907.44
4319-017-214	Cp Propco Llc	2025 Avenue Of The Stars #1420	Zone 1	\$820.44
4319-017-215	Cp Propco Llc	2025 Avenue Of The Stars #1421	Zone 1	\$802.04
4319-017-216	Cp Propco Llc	2025 Avenue Of The Stars #1601	Zone 1	\$1,268.14
4319-017-217	Cp Propco Llc	2025 Avenue Of The Stars #1602	Zone 1	\$574.51
4319-017-218	Cp Propco Llc	2025 Avenue Of The Stars #1603	Zone 1	\$1,001.80
4319-017-219	Cp Propco Llc	2025 Avenue Of The Stars #1604	Zone 1	\$587.56
4319-017-220	Cp Propco Llc	2025 Avenue Of The Stars #1605	Zone 1	\$583.21
4319-017-221	Cp Propco Llc	2025 Avenue Of The Stars #1606	Zone 1	\$1,054.00
4319-017-222	Cp Propco Llc	2025 Avenue Of The Stars #1607	Zone 1	\$516.29
4319-017-223	Cp Propco Llc	2025 Avenue Of The Stars #1608	Zone 1	\$518.63
4319-017-224	Ronald Geller Living Trust	2025 Avenue Of The Stars #1609	Zone 1	\$640.09
4319-017-225	Cp Propco Llc	2025 Avenue Of The Stars #1610	Zone 1	\$553.77
4319-017-226	Emt Investment Inc	2025 Avenue Of The Stars #1611	Zone 1	\$552.76
4319-017-227	1 West Century Drive 6ab Trust	1 W Century Dr #6b	Zone 1	\$2,710.27
4319-018-001	Next Century Partners Llc	115 W Park Cir #3a	Zone 1	\$799.70
4319-018-002	Next Century Partners Llc	115 W Park Cir #3b	Zone 1	\$930.19
4319-018-003	Next Century Partners Llc	115 W Park Cir #3c	Zone 1	\$598.94
4319-018-004	Next Century Partners Llc	115 W Park Cir #3d	Zone 1	\$448.37
4319-018-005	Next Century Partners Llc	115 W Park Cir #4a	Zone 1	\$799.70
4319-018-006	Next Century Partners Llc	115 W Park Cir #4b	Zone 1	\$930.19
4319-018-007	Next Century Partners Llc	115 W Park Cir #4c	Zone 1	\$598.94
4319-018-008	Next Century Partners Llc	115 W Park Cir #4d	Zone 1	\$448.37
4319-018-009	Next Century Partners Llc	115 W Park Cir #5a	Zone 1	\$799.70
4319-018-010	Next Century Partners Llc	115 W Park Cir #5b	Zone 1	\$930.19
4319-018-011	Next Century Partners Llc	115 W Park Cir #5c	Zone 1	\$598.94
4319-018-012	Next Century Partners Llc	115 W Park Cir #5d	Zone 1	\$448.37
4319-018-013	Next Century Partners Llc	115 W Park Cir #6a	Zone 1	\$799.70
4319-018-014	Next Century Partners Llc	115 W Park Cir #6b	Zone 1	\$930.19
4319-018-015	Next Century Partners Llc	115 W Park Cir #6c	Zone 1	\$598.94
4319-018-016	Next Century Partners Llc	115 W Park Cir #6d	Zone 1	\$448.37
4319-018-017	Next Century Partners Llc	115 W Park Cir #7a	Zone 1	\$799.70
4319-018-018	Next Century Partners Llc	115 W Park Cir #7b	Zone 1	\$930.19
4319-018-019	Next Century Partners Llc	115 W Park Cir #7c	Zone 1	\$598.94
4319-018-020	Next Century Partners Llc	115 W Park Cir #7d	Zone 1	\$448.37
4319-018-021	Next Century Partners Llc	115 W Park Cir #8a	Zone 1	\$799.70
4319-018-022	Next Century Partners Llc	115 W Park Cir #8b	Zone 1	\$930.19
4319-018-023	Next Century Partners Llc	115 W Park Cir #8c	Zone 1	\$598.94

APN	OWNER NAME	SITE ADDRESS	BENEFIT ZONE	PARCEL ASSMT
4319-018-024	Next Century Partners Llc	115 W Park Cir #8d	Zone 1	\$448.37
4319-018-025	Next Century Partners Llc	115 W Park Cir #9a	Zone 1	\$799.70
4319-018-026	Next Century Partners Llc	115 W Park Cir #9b	Zone 1	\$930.19
4319-018-027	Next Century Partners Llc	115 W Park Cir #9c	Zone 1	\$598.94
4319-018-028	Next Century Partners Llc	115 W Park Cir #9d	Zone 1	\$448.37
4319-018-029	Next Century Partners Llc	115 W Park Cir #10a	Zone 1	\$806.39
4319-018-030	Next Century Partners Llc	115 W Park Cir #10b	Zone 1	\$936.89
4319-018-031	Next Century Partners Llc	115 W Park Cir #10c	Zone 1	\$598.94
4319-018-032	Next Century Partners Llc	115 W Park Cir #10d	Zone 1	\$448.37
4319-018-033	Next Century Partners Llc	115 W Park Cir #11a	Zone 1	\$806.39
4319-018-034	Next Century Partners Llc	115 W Park Cir #11b	Zone 1	\$936.89
4319-018-035	Next Century Partners Llc	115 W Park Cir #11c	Zone 1	\$598.94
4319-018-036	Next Century Partners Llc	115 W Park Cir #11d	Zone 1	\$448.37
4319-018-037	Next Century Partners Llc	115 W Park Cir #12a	Zone 1	\$806.39
4319-018-038	Next Century Partners Llc	115 W Park Cir #12b	Zone 1	\$936.89
4319-018-039	Next Century Partners Llc	115 W Park Cir #12c	Zone 1	\$598.94
4319-018-040	Next Century Partners Llc	115 W Park Cir #12d	Zone 1	\$448.37
4319-018-041	Next Century Partners Llc	115 W Park Cir #13a	Zone 1	\$806.39
4319-018-042	Next Century Partners Llc	115 W Park Cir #13b	Zone 1	\$936.89
4319-018-043	Next Century Partners Llc	115 W Park Cir #13c	Zone 1	\$598.94
4319-018-044	Next Century Partners Llc	115 W Park Cir #13d	Zone 1	\$448.37
4319-018-045	Next Century Partners Llc	115 W Park Cir #14a	Zone 1	\$806.39
4319-018-046	Next Century Partners Llc	115 W Park Cir #14b	Zone 1	\$936.89
4319-018-047	Next Century Partners Llc	115 W Park Cir #14c	Zone 1	\$598.94
4319-018-048	Next Century Partners Llc	115 W Park Cir #14d	Zone 1	\$448.37
4319-018-049	Next Century Partners Llc	115 W Park Cir #15a	Zone 1	\$806.39
4319-018-050	Next Century Partners Llc	115 W Park Cir #15b	Zone 1	\$936.89
4319-018-051	Next Century Partners Llc	115 W Park Cir #15c	Zone 1	\$598.94
4319-018-052	Next Century Partners Llc	115 W Park Cir #15d	Zone 1	\$448.37
4319-018-053	Next Century Partners Llc	115 W Park Cir #16a	Zone 1	\$806.39
4319-018-054	Next Century Partners Llc	115 W Park Cir #16b	Zone 1	\$936.89
4319-018-055	Next Century Partners Llc	115 W Park Cir #16c	Zone 1	\$598.94
4319-018-056	Next Century Partners Llc	115 W Park Cir #16d	Zone 1	\$448.37
4319-018-057	Next Century Partners Llc	115 W Park Cir #17a	Zone 1	\$1,154.38
4319-018-058	Next Century Partners Llc	115 W Park Cir #17b	Zone 1	\$729.43
4319-018-059	Next Century Partners Llc	115 W Park Cir #17c	Zone 1	\$946.92
4319-018-060	Next Century Partners Llc	115 W Park Cir #18a	Zone 1	\$1,154.38
4319-018-061	Next Century Partners Llc	115 W Park Cir #18b	Zone 1	\$729.43
4319-018-062	Next Century Partners Llc	115 W Park Cir #18c	Zone 1	\$946.92
4319-018-063	Next Century Partners Llc	115 W Park Cir #19a	Zone 1	\$1,154.38
4319-018-064	Next Century Partners Llc	115 W Park Cir #19b	Zone 1	\$729.43
4319-018-065	Next Century Partners Llc	115 W Park Cir #19c	Zone 1	\$946.92
4319-018-066	Next Century Partners Llc	115 W Park Cir #20a	Zone 1	\$1,154.38
4319-018-067	Next Century Partners Llc	115 W Park Cir #20b	Zone 1	\$729.43
4319-018-068	Next Century Partners Llc	115 W Park Cir #20c	Zone 1	\$946.92

APN	OWNER NAME	SITE ADDRESS	BENEFIT ZONE	PARCEL ASSMT
4319-018-069	Next Century Partners Llc	115 W Park Cir #21a	Zone 1	\$1,154.38
4319-018-070	Next Century Partners Llc	115 W Park Cir #21b	Zone 1	\$729.43
4319-018-071	Next Century Partners Llc	115 W Park Cir #21c	Zone 1	\$946.92
4319-018-072	Next Century Partners Llc	115 W Park Cir #22a	Zone 1	\$1,154.38
4319-018-073	Next Century Partners Llc	115 W Park Cir #22b	Zone 1	\$729.43
4319-018-074	Next Century Partners Llc	115 W Park Cir #22c	Zone 1	\$946.92
4319-018-075	Next Century Partners Llc	115 W Park Cir #23a	Zone 1	\$1,154.38
4319-018-076	Next Century Partners Llc	115 W Park Cir #23b	Zone 1	\$729.43
4319-018-077	Next Century Partners Llc	115 W Park Cir #23c	Zone 1	\$946.92
4319-018-078	Next Century Partners Llc	115 W Park Cir #24a	Zone 1	\$1,154.38
4319-018-079	Next Century Partners Llc	115 W Park Cir #24b	Zone 1	\$729.43
4319-018-080	Next Century Partners Llc	115 W Park Cir #24c	Zone 1	\$946.92
4319-018-081	Next Century Partners Llc	115 W Park Cir #25a	Zone 1	\$1,154.38
4319-018-082	Next Century Partners Llc	115 W Park Cir #25b	Zone 1	\$729.43
4319-018-083	Next Century Partners Llc	115 W Park Cir #25c	Zone 1	\$946.92
4319-018-084	Next Century Partners Llc	115 W Park Cir #26a	Zone 1	\$1,284.87
4319-018-085	Next Century Partners Llc	115 W Park Cir #26b	Zone 1	\$729.43
4319-018-086	Next Century Partners Llc	115 W Park Cir #26c	Zone 1	\$809.74
4319-018-087	Next Century Partners Llc	115 W Park Cir #27a	Zone 1	\$1,284.87
4319-018-088	Next Century Partners Llc	115 W Park Cir #27b	Zone 1	\$729.43
4319-018-089	Next Century Partners Llc	115 W Park Cir #27c	Zone 1	\$809.74
4319-018-090	Next Century Partners Llc	115 W Park Cir #28a	Zone 1	\$1,284.87
4319-018-091	Next Century Partners Llc	115 W Park Cir #28b	Zone 1	\$729.43
4319-018-092	Next Century Partners Llc	115 W Park Cir #28c	Zone 1	\$809.74
4319-018-093	Next Century Partners Llc	115 W Park Cir #29a	Zone 1	\$1,284.87
4319-018-094	Next Century Partners Llc	115 W Park Cir #29b	Zone 1	\$729.43
4319-018-095	Next Century Partners Llc	115 W Park Cir #29c	Zone 1	\$809.74
4319-018-096	Next Century Partners Llc	115 W Park Cir #30a	Zone 1	\$1,284.87
4319-018-097	Next Century Partners Llc	115 W Park Cir #30b	Zone 1	\$729.43
4319-018-098	Next Century Partners Llc	115 W Park Cir #30c	Zone 1	\$809.74
4319-018-099	Next Century Partners Llc	115 W Park Cir #31a	Zone 1	\$1,284.87
4319-018-100	Next Century Partners Llc	115 W Park Cir #31b	Zone 1	\$729.43
4319-018-101	Next Century Partners Llc	115 W Park Cir #31c	Zone 1	\$809.74
4319-018-102	Next Century Partners Llc	115 W Park Cir #32a	Zone 1	\$1,284.87
4319-018-103	Next Century Partners Llc	115 W Park Cir #32b	Zone 1	\$729.43
4319-018-104	Next Century Partners Llc	115 W Park Cir #32c	Zone 1	\$809.74
4319-018-105	Next Century Partners Llc	115 W Park Cir #33a	Zone 1	\$1,284.87
4319-018-106	Next Century Partners Llc	115 W Park Cir #33b	Zone 1	\$729.43
4319-018-107	Next Century Partners Llc	115 W Park Cir #33c	Zone 1	\$809.74
4319-018-108	Next Century Partners Llc	115 W Park Cir #34a	Zone 1	\$1,284.87
4319-018-109	Next Century Partners Llc	115 W Park Cir #34b	Zone 1	\$729.43
4319-018-110	Next Century Partners Llc	115 W Park Cir #34c	Zone 1	\$809.74
4319-018-111	Next Century Partners Llc	115 W Park Cir #35a	Zone 1	\$1,284.87
4319-018-112	Next Century Partners Llc	115 W Park Cir #35b	Zone 1	\$729.43
4319-018-113	Next Century Partners Llc	115 W Park Cir #35c	Zone 1	\$809.74

APN	OWNER NAME	SITE ADDRESS	BENEFIT ZONE	PARCEL ASSMT
4319-018-114	Next Century Partners Llc	115 W Park Cir #36a	Zone 1	\$1,274.83
4319-018-115	Next Century Partners Llc	115 W Park Cir #36b	Zone 1	\$1,562.59
4319-018-116	Next Century Partners Llc	115 W Park Cir #37a	Zone 1	\$1,274.83
4319-018-117	Next Century Partners Llc	115 W Park Cir #37b	Zone 1	\$1,562.59
4319-018-118	Next Century Partners Llc	115 W Park Cir #38a	Zone 1	\$1,274.83
4319-018-119	Next Century Partners Llc	115 W Park Cir #38b	Zone 1	\$1,562.59
4319-018-120	Next Century Partners Llc	115 W Park Cir #39a	Zone 1	\$1,274.83
4319-018-121	Next Century Partners Llc	115 W Park Cir #39b	Zone 1	\$1,562.59
4319-018-122	Next Century Partners Llc	115 W Park Cir #40a	Zone 1	\$1,274.83
4319-018-123	Next Century Partners Llc	115 W Park Cir #40b	Zone 1	\$1,562.59
4319-018-124	Next Century Partners Llc	115 W Park Cir #41	Zone 1	\$2,840.77
4319-018-125	Next Century Partners Llc	115 W Park Cir #42	Zone 1	\$2,840.77
4319-018-126	Next Century Partners Llc	115 W Park Cir #43	Zone 1	\$2,840.77
4319-019-001	Next Century Partners Llc	211 W Elm Ct #3a	Zone 1	\$685.93
4319-019-002	Solly Yamin	211 W Elm Ct #3b	Zone 1	\$604.29
4319-019-003	Asadullah Jung Revocable Living Trust	211 W Elm Ct #3c	Zone 1	\$314.53
4319-019-004	Imtiaz & Nazmira Tar	211 W Elm Ct #3d	Zone 1	\$598.94
4319-019-005	2025 Aos 3e Llc	211 W Elm Ct #3e	Zone 1	\$562.13
4319-019-006	Next Century Partners Llc	211 W Elm Ct #4a	Zone 1	\$685.93
4319-019-007	Martin Gilkes & Yong Ji	211 W Elm Ct #4b	Zone 1	\$585.55
4319-019-008	Niki Ghazi	211 W Elm Ct #4c	Zone 1	\$314.53
4319-019-009	Cho Family Trust	211 W Elm Ct #4d	Zone 1	\$598.94
4319-019-010	Salopek Trust	211 W Elm Ct #4e	Zone 1	\$562.13
4319-019-011	Next Century Partners Llc	211 W Elm Ct #5a	Zone 1	\$685.93
4319-019-012	Next Century Partners Llc	211 W Elm Ct #5b	Zone 1	\$585.55
4319-019-013	5clm Llc	211 W Elm Ct #5c	Zone 1	\$314.53
4319-019-014	Next Century Partners Llc	211 W Elm Ct #5d	Zone 1	\$612.32
4319-019-015	Fifteen Kids Residential Real Estate Llc	211 W Elm Ct #5e	Zone 1	\$562.13
4319-019-016	Next Century Partners Llc	211 W Elm Ct #6a	Zone 1	\$685.93
4319-019-017	Next Century Partners Llc	211 W Elm Ct #6b	Zone 1	\$604.29
4319-019-018	Fengying Liang	211 W Elm Ct #6c	Zone 1	\$314.53
4319-019-019	Next Century Partners Llc	211 W Elm Ct #6d	Zone 1	\$598.94
4319-019-020	Koala Tree Trust	211 W Elm Ct #6e	Zone 1	\$562.13
4319-019-021	Next Century Partners Llc	211 W Elm Ct #7a	Zone 1	\$685.93
4319-019-022	Sofniy Enterprise Inc	211 W Elm Ct #7b	Zone 1	\$585.55
4319-019-023	Sofniy Enterprise Inc	211 W Elm Ct #7c	Zone 1	\$314.53
4319-019-024	Next Century Partners Llc	211 W Elm Ct #7d	Zone 1	\$598.94
4319-019-025	Next Century Partners Llc	211 W Elm Ct #7e	Zone 1	\$562.13
4319-019-026	Four D Llc	211 W Elm Ct #8a	Zone 1	\$685.93
4319-019-027	Next Century Partners Llc	211 W Elm Ct #8b	Zone 1	\$585.55
4319-019-028	Next Century Partners Llc	211 W Elm Ct #8c	Zone 1	\$314.53
4319-019-029	Next Century Partners Llc	211 W Elm Ct #8d	Zone 1	\$598.94
4319-019-030	Next Century Partners Llc	211 W Elm Ct #8e	Zone 1	\$562.13
4319-019-031	Next Century Partners Llc	211 W Elm Ct #9a	Zone 1	\$685.93

APN	OWNER NAME	SITE ADDRESS	BENEFIT ZONE	PARCEL ASSMT
4319-019-032	211b Elm Court Llc	211 W Elm Ct #9b	Zone 1	\$585.55
4319-019-033	211c Elm Court Llc	211 W Elm Ct #9c	Zone 1	\$321.89
4319-019-034	Next Century Partners Llc	211 W Elm Ct #9d	Zone 1	\$598.94
4319-019-035	Amedeo Ursini Trust	211 W Elm Ct #9e	Zone 1	\$569.49
4319-019-036	Next Century Partners Llc	211 W Elm Ct #10a	Zone 1	\$689.28
4319-019-037	Next Century Partners Llc	211 W Elm Ct #10b	Zone 1	\$588.90
4319-019-038	Mamiko Nishiyama Trust	211 W Elm Ct #10c	Zone 1	\$317.87
4319-019-039	Next Century Partners Llc	211 W Elm Ct #10d	Zone 1	\$598.94
4319-019-040	Next Century Partners Llc	211 W Elm Ct #10e	Zone 1	\$565.48
4319-019-041	Next Century Partners Llc	211 W Elm Ct #11a	Zone 1	\$689.28
4319-019-042	Next Century Partners Llc	211 W Elm Ct #11b	Zone 1	\$588.90
4319-019-043	Next Century Partners Llc	211 W Elm Ct #11c	Zone 1	\$317.87
4319-019-044	Next Century Partners Llc	211 W Elm Ct #11d	Zone 1	\$598.94
4319-019-045	Next Century Partners Llc	211 W Elm Ct #11e	Zone 1	\$565.48
4319-019-046	Lin Ya Chen Sarah Tr	211 W Elm Ct #12a	Zone 1	\$689.28
4319-019-047	Next Century Partners Llc	211 W Elm Ct #12b	Zone 1	\$588.90
4319-019-048	Xuejun Hu	211 W Elm Ct #12c	Zone 1	\$317.87
4319-019-049	Next Century Partners Llc	211 W Elm Ct #12d	Zone 1	\$598.94
4319-019-050	Meenu V Sachar Trust	211 W Elm Ct #12e	Zone 1	\$565.48
4319-019-051	Next Century Partners Llc	211 W Elm Ct #13a	Zone 1	\$689.28
4319-019-052	Next Century Partners Llc	211 W Elm Ct #13b	Zone 1	\$588.90
4319-019-053	Next Century Partners Llc	211 W Elm Ct #13c	Zone 1	\$317.87
4319-019-054	Next Century Partners Llc	211 W Elm Ct #13d	Zone 1	\$598.94
4319-019-055	Next Century Partners Llc	211 W Elm Ct #13e	Zone 1	\$576.52
4319-019-056	Gilbert Richmond Trust	211 W Elm Ct #14a	Zone 1	\$689.28
4319-019-057	Next Century Partners Llc	211 W Elm Ct #14b	Zone 1	\$588.90
4319-019-058	Next Century Partners Llc	211 W Elm Ct #14c	Zone 1	\$325.23
4319-019-059	Next Century Partners Llc	211 W Elm Ct #14d	Zone 1	\$598.94
4319-019-060	Abraham Somer Administrative Trust	211 W Elm Ct #14e	Zone 1	\$565.48
4319-019-061	Next Century Partners Llc	211 W Elm Ct #15a	Zone 1	\$715.71
4319-019-062	Century Horizon Llc	211 W Elm Ct #15b	Zone 1	\$588.90
4319-019-063	Julius Deboer	211 W Elm Ct #15c	Zone 1	\$317.87
4319-019-064	Next Century Partners Llc	211 W Elm Ct #15d	Zone 1	\$598.94
4319-019-065	Bobby Lo Living Trust	211 W Elm Ct #15e	Zone 1	\$565.48
4319-019-066	Next Century Partners Llc	211 W Elm Ct #16a	Zone 1	\$689.28
4319-019-067	Next Century Partners Llc	211 W Elm Ct #16b	Zone 1	\$588.90
4319-019-068	Abraham Somer Administrative Trust	211 W Elm Ct #16c	Zone 1	\$317.87
4319-019-069	Next Century Partners Llc	211 W Elm Ct #16d	Zone 1	\$598.94
4319-019-070	Next Century Partners Llc	211 W Elm Ct #16e	Zone 1	\$565.48
4319-019-071	Cp Propco Llc	211 W Elm Ct #17a	Zone 1	\$1,110.88
4319-019-072	Dean Family Trust	211 W Elm Ct #17b	Zone 1	\$796.35
4319-019-073	Cp Propco Llc	211 W Elm Ct #17c	Zone 1	\$946.92
4319-019-074	One11 Llc	211 W Elm Ct #18a	Zone 1	\$1,084.11
4319-019-075	Cp Propco Llc	211 W Elm Ct #18b	Zone 1	\$796.35
4319-019-076	Ann Century Trust	211 W Elm Ct #18c	Zone 1	\$946.92

APN	OWNER NAME	SITE ADDRESS	BENEFIT ZONE	PARCEL ASSMT
4319-019-077	Next Century Partners Llc	211 W Elm Ct #19a	Zone 1	\$1,084.11
4319-019-078	Next Century Partners Llc	211 W Elm Ct #19b	Zone 1	\$796.35
4319-019-079	Next Century Partners Llc	211 W Elm Ct #19c	Zone 1	\$946.92
4319-019-080	Cp Propco Llc	211 W Elm Ct #20a	Zone 1	\$1,110.88
4319-019-081	Cp Propco Llc	211 W Elm Ct #20b	Zone 1	\$834.83
4319-019-082	Cp Propco Llc	211 W Elm Ct #20c	Zone 1	\$946.92
4319-019-083	Cp Propco Llc	211 W Elm Ct #21a	Zone 1	\$1,084.11
4319-019-084	Cp Propco Llc	211 W Elm Ct #21b	Zone 1	\$796.35
4319-019-085	Cp Propco Llc	211 W Elm Ct #21c	Zone 1	\$715.71
4319-019-086	Steven Sukhwa Koh And Jung Ok Koh Family Trus	211 W Elm Ct #22a	Zone 1	\$1,084.11
4319-019-087	Eddie & Eunkyoungh Jhin	211 W Elm Ct #22b	Zone 1	\$796.35
4319-019-088	Cp Propco Llc	211 W Elm Ct #22c	Zone 1	\$946.92
4319-019-089	Brandon Edwards Living Trust	211 W Elm Ct #23a	Zone 1	\$1,084.11
4319-019-090	Cp Propco Llc	211 W Elm Ct #23b	Zone 1	\$796.35
4319-019-091	Cp Propco Llc	211 W Elm Ct #23c	Zone 1	\$946.92
4319-019-092	Cp Propco Llc	211 W Elm Ct #24a	Zone 1	\$1,084.11
4319-019-093	Evlynn S Markowitz Trust &	211 W Elm Ct #24b	Zone 1	\$796.35
4319-019-094	Cp Propco Llc	211 W Elm Ct #24c	Zone 1	\$946.92
4319-019-095	Cp Propco Llc	211 W Elm Ct #25a	Zone 1	\$1,084.11
4319-019-096	Cp Propco Llc	211 W Elm Ct #25b	Zone 1	\$834.83
4319-019-097	Cp Propco Llc	211 W Elm Ct #25c	Zone 1	\$946.92
4319-019-098	Papillon Bleu 111 Llc	211 W Elm Ct #26a	Zone 1	\$1,430.09
4319-019-099	Next Century Partners Llc	211 W Elm Ct #26b	Zone 1	\$732.78
4319-019-100	Francis & Lynn Wagner Trust	211 W Elm Ct #26c	Zone 1	\$803.04
4319-019-101	Cp Propco Llc	211 W Elm Ct #27a	Zone 1	\$1,281.53
4319-019-102	Next Century Partners Llc	211 W Elm Ct #27b	Zone 1	\$732.78
4319-019-103	Cp Propco Llc	211 W Elm Ct #27c	Zone 1	\$813.08
4319-019-104	Cp Propco Llc	211 W Elm Ct #28a	Zone 1	\$1,281.53
4319-019-105	Next Century Partners Llc	211 W Elm Ct #28b	Zone 1	\$732.78
4319-019-106	Cp Propco Llc	211 W Elm Ct #28c	Zone 1	\$813.08
4319-019-107	Cp Propco Llc	211 W Elm Ct #29a	Zone 1	\$1,281.53
4319-019-108	Cp Propco Llc	211 W Elm Ct #29b	Zone 1	\$732.78
4319-019-109	Cp Propco Llc	211 W Elm Ct #29c	Zone 1	\$813.08
4319-019-110	Cp Propco Llc	211 W Elm Ct #30a	Zone 1	\$1,281.53
4319-019-111	Cp Propco Llc	211 W Elm Ct #30b	Zone 1	\$732.78
4319-019-112	Victor Shaheen & Sheila Ardalan	211 W Elm Ct #30c	Zone 1	\$813.08
4319-019-113	Cp Propco Llc	211 W Elm Ct #31a	Zone 1	\$1,281.53
4319-019-114	Cp Propco Llc	211 W Elm Ct #31b	Zone 1	\$732.78
4319-019-115	Century Elm Llc	211 W Elm Ct #31c	Zone 1	\$813.08
4319-019-116	Cp Propco Llc	211 W Elm Ct #32a	Zone 1	\$1,281.53
4319-019-117	Cp Propco Llc	211 W Elm Ct #32b	Zone 1	\$732.78
4319-019-118	Cp Propco Llc	211 W Elm Ct #32c	Zone 1	\$813.08
4319-019-119	Cp Propco Llc	211 W Elm Ct #33a	Zone 1	\$1,281.53
4319-019-120	Cp Propco Llc	211 W Elm Ct #33b	Zone 1	\$732.78

APN	OWNER NAME	SITE ADDRESS	BENEFIT ZONE	PARCEL ASSMT
4319-019-121	Cp Propco Llc	211 W Elm Ct #33c	Zone 1	\$843.53
4319-019-122	Cp Propco Llc	211 W Elm Ct #34a	Zone 1	\$1,281.53
4319-019-123	Cp Propco Llc	211 W Elm Ct #34b	Zone 1	\$732.78
4319-019-124	Cp Propco Llc	211 W Elm Ct #34c	Zone 1	\$813.08
4319-019-125	Cp Propco Llc	211 W Elm Ct #35a	Zone 1	\$1,281.53
4319-019-126	Cp Propco Llc	211 W Elm Ct #35b	Zone 1	\$732.78
4319-019-127	Tae Lee & Sook Hyun	211 W Elm Ct #35c	Zone 1	\$813.08
4319-019-128	Cp Propco Llc	211 W Elm Ct #36a	Zone 1	\$1,288.22
4319-019-129	Cp Propco Llc	211 W Elm Ct #36b	Zone 1	\$736.12
4319-019-130	La Woman Llc	211 W Elm Ct #36c	Zone 1	\$816.43
4319-019-131	Cpt 37n Llc	211 W Elm Ct #37a	Zone 1	\$1,288.22
4319-019-132	Cpt 37n Llc	211 W Elm Ct #37b	Zone 1	\$736.12
4319-019-133	Cpt 37n Llc	211 W Elm Ct #37c	Zone 1	\$816.43
4319-019-134	Cp Propco Llc	211 W Elm Ct #38a	Zone 1	\$1,288.22
4319-019-135	Cp Propco Llc	211 W Elm Ct #38b	Zone 1	\$736.12
4319-019-136	Cp Propco Llc	211 W Elm Ct #38c	Zone 1	\$816.43
4319-019-137	Next Century Partners Llc	211 W Elm Ct #39a	Zone 1	\$1,284.87
4319-019-138	Next Century Partners Llc	211 W Elm Ct #39b	Zone 1	\$1,555.90
4319-019-139	Cp Propco Llc	211 W Elm Ct #40a	Zone 1	\$1,288.22
4319-019-140	Cp Propco Llc	211 W Elm Ct #40b	Zone 1	\$736.12
4319-019-141	Cp Propco Llc	211 W Elm Ct #41	Zone 1	\$2,840.77
4319-019-142	Cp Propco Llc	211 W Elm Ct #42	Zone 1	\$2,840.77
4319-019-143	Cp Propco Llc	211 W Elm Ct #43	Zone 1	\$2,840.77
TOTAL:				\$3,686,000