

ACCELERATED REVIEW PROCESS -C

Office of the City Engineer

Los Angeles, California

To the Honorable Council

4/22/2026

Of the City of Los Angeles

Honorable Members:

C. D. No. 5

SUBJECT:

Offer to dedicate an easement for sidewalk purposes on 1900 South Avenue of the Stars.

- Right of Way No. 36000-10352.

RECOMMENDATIONS:

- A. That the petitioner's offer to dedicate the easement for sidewalk purposes lying on 1900 South Avenue of the Stars, substantially as shown hatched on the attached Exhibit "B", be accepted.
- B. That the Board of Public Works be authorized to acquire the dedication.
- C. That a copy of the Council action on this project be forwarded to the Survey Division of the Bureau of Engineering for processing.
- D. That the notification of the time and place of the Public Works and Gang Reduction Committee to consider this matter be sent to:
 1. David Felman
1900 Avenue of the Stars
Los Angeles, CA 90067

FISCAL IMPACT STATEMENT:

A fee of \$3,416.51 was paid for processing this report pursuant to Sections 7.3 and 7.41.1 of the Administrative Code. No additional City Funds are needed.

TRANSMITTALS:

1. Application dated April 24, 2025, from David Felman.
2. Exhibit "B", location map.

DISCUSSION:

The petitioner, David Felman, is offering to dedicate the sidewalk easement lying on 1900 South Avenue of the Stars, over the properties substantially shown hatched on the attached Exhibit "B".

The investigation fees required under Sections 7.3 and 7.41.1 of the Administrative Code have been paid by the petitioner.

ENVIRONMENTAL DETERMINATION:

The Bureau of Engineering has determined that this project is exempt from the California Environmental Quality Act of 1970, pursuant to the categorical exemptions included in the City of Los Angeles Guidelines under Article III, Class 5(4).

Respectfully submitted,

A handwritten signature in blue ink, appearing to read 'W. Knight', with a stylized arrow pointing to the right.

William Knight, Engineer of Surveys
Survey Division
Bureau of Engineering

dedrpt_10352

cc: West Los Angeles District

Applicant Type

Highway Dedication Type : **Highway Dedication**

Applicant Information

Reference number:	202410675
Full Name:	KPFF
Address:	700 S FLOWER ST SUITE 2100
City:	LOS ANGELES
State:	CA
Zip:	90017
Phone:	2134189156
Email:	kenda.finch@kpff.com

Owner Information

Full Name :	David Felman
Address :	1900 AVENUE OF THE STARS
City :	LOS ANGELES
State :	CA
Zip :	90067
Phone :	310-203-1870
Email :	David@andersonholdings.com

Property Information

Job Address:	1900 S AVENUE OF THE STARS
Building Permit Application No. :	
RW No.:	36000-10352
Planning Case Number :	
Tract :	

Block :
Lot :
Arb. :

Project Information (if applicable)

Project Title :
Project Engineer (if City project) :
Project Engineer Title (if City project) :
Work Order or I.D.O. (if City project) :
B-Permit Number (if applicable) :
Work Description : sidewalk easement

Dedication Information

The Area to be dedicated is for:
<input type="checkbox"/> Street
<input type="checkbox"/> Alley
<input checked="" type="checkbox"/> Sidewalk
<input type="checkbox"/> Sanitary Sewer
<input type="checkbox"/> Storm Drain
<input type="checkbox"/> Other
Explain: N/A
The area dedicated is located at:
Engineering District: N/A Planning District :
Council District Number : District Map Number :
Thomas Guide Page and Grid :
Description of Dedication: SIDEWALK EASEMENT
Reason for Dedication: BUS PAD CAUSING SIDEWALK EASEMENT

The dedication is required by

R3 - Hwy
Dedication

CPC Planning Number:

ZA Planning Number:

DOT

Hillside
Ordinance

Voluntary Dedication

Explain:
N/A

Boe Counter Comments

No Comments.

Survey Comments

No Comments.

Real Estate Comments

No Comments.

Mapping Comments

No Comments.

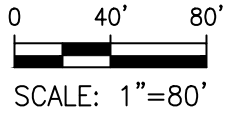

ABBREVIATIONS:

- ☉ CENTERLINE
- MB MAP BOOK
- PMB PARCEL MAP BOOK
- POB POINT OF BEGINNING
- R/W RIGHT-OF-WAY
- TPOB TRUE POINT OF BEGINNING



PROPOSED EASEMENT AREA
974 SQ. FT., 0.022 ACRES
MORE OR LESS

LINETYPES:

- — — — — CENTERLINE
- - - - - LOT LINE
- RIGHT-OF-WAY LINE

TRACT NO. 30364
MB 803/63-64

PARCEL MAP-L.A.
NO. 1852
PMB 23/15

PARCEL B

7

6

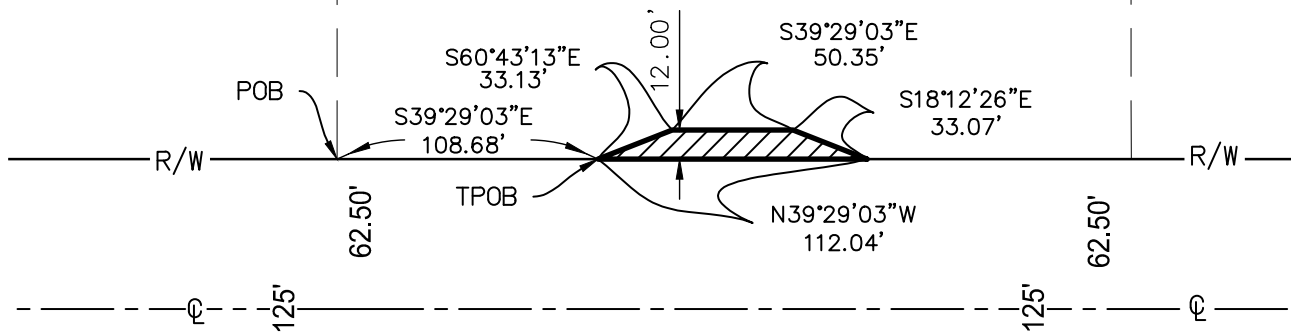

AVENUE OF THE STARS
(PUBLIC STREET)

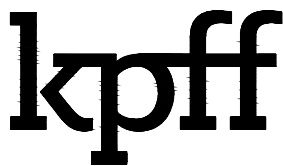

700 South Flower St., Suite 2100
Los Angeles, CA 90017
O: 213.418.0201
F: 213.266.5294
www.kpff.com

EXHIBIT "B" PROPOSED EASEMENT	DATE: 11-22-2024
	DRAWN BY: CS
CITY OF LOS ANGELES/ COUNTY OF LOS ANGELES/ STATE OF CALIFORNIA	CHECKED BY: DB
	PROJECT NO. 2200174
	SHEET: 2 OF 2